

# "Your One Stop Valve Maintenance Source"™





Hello from all of us at Melancon Energy Products. Since our humble beginnings in 1987, we have made every effort to be of genuine service to you. Our continued growth is a direct result of the support of our valued customers from all over the world.

We realize the day to day importance of sharing our knowledge with you. We appreciate your trust in us to provide you consistently with quality products, impeccable service and on time deliveries.

Together, over the years, we have been fortunate to solve many various valve issues. We give you solid answers to your questions and concerns. We think this allows all of us to work in a safer environment. Our goal from the first day has been to get the job done properly and return home to our families.

We appreciate the many years of ongoing support and the opportunity to work with you. We will always maintain the integrity you deserve and strive to be *"Your One Stop Valve Maintenance Source"*.

Please let us know when we may be of service to you. We will do everything humanly possible to respond to your needs promptly and professionally.

I hope you have a great and safe day.

Respectfully,

A handwritten signature in cursive script that reads "Alan D. Melancon". The ink is dark and the signature is fluid.

Alan D. Melancon  
President





# MELANCON ENERGY PRODUCTS

**“Your One Stop Valve Maintenance Source”**

## Product Index

Page No.

<b>Valve Lube Sealants</b> .....	2 - 6
Stick and Bulk Forms	
Emergency & Specialty Valve Lubricants and Sealants	
Ordering Information for Valve Lube Sealants	
Valve Lube Sealant Capacity Charts	
<b>Emergency and Specialty Valve Lube Sealants</b> .....	4 - 5
<b>Valve Cleaner and Valve Purge</b> .....	7
<b>Valve Lubrication Fittings, Adapters and Tools</b> .....	8 - 10
Giant Button Head Fittings	
Fitting Chart for Lubricated Plug Valves	
Capped Style Fittings, Packing Injectors & Couplers	
Safety Adapters, Specialty Fittings, Body Vents & Tools	
<b>High Pressure Valve Lubrication Guns and Accessories</b> .....	11 - 14
Air Operated Valve Lubrication Pumps up to 15,000 psi	
Hydraulic Lubrication Gun	
Protective Carrying Case for Hydraulic Gun	
Hydraulic – Exchange Program (all major brands)	
Battery Powered EE-33-CT .....	14
Manual – Screw Type and Bucket Pump	
<b>Valve Stem Packing</b> .....	15
Injection Type	
Hydraulic Packing Gun & Packing Adapters	
<b>Spare Parts</b> .....	16 - 17
Hose Assembly Parts	
In-Line Check Valves	
Adjustment Screws and Caps for Hypreseal Plug Valves	
Senior Orifice Fitting Products	
<b>Valve Safety &amp; Maintenance Training and Valve Repair</b> .....	18
Valve Consulting and Troubleshooting Service	
Valve Safety and Maintenance Training Classes	
<b>Valve Repair and Testing</b> .....	18
<b>MELANCON Ball Valves</b> .....	19 - 26
Stainless Steel & Carbon Steel • Full or Reduced Port	
Threaded (2,000 - 10,000 psi) • Socket Weld • RF • RTJ • Weld	
Flanged End - API-6D, ANSI 150 thru 2500 Class	
Ordering Information for Ball Valves	
<b>Project Materials</b> .....	27
Pipe, Valves, Fittings, Flanges & Gaskets	
<b>Gate Valves: API-6A Wellhead PSL1 thru PSL3</b> .....	28
2,000 to 15,000 psi Working Pressure	
<b>Gauges</b> .....	29 - 33
Stainless Steel • Brass • Liquid Filled	
Process • Differential • Low Pressure	
Test Gauges • Gauge Kits	
<b>Instrument Manifolds and Needle Valves</b> .....	34
<b>Closures and Closure Seals</b> .....	35 - 36
<b>Penetrating Oil and Degreaser</b> .....	37







# MELANCON ENERGY PRODUCTS

## Multi-Purpose Valve Lube Sealants\*

(Stick & Bulk Forms)



### For Hydraulic Guns

- A. "J" Size Sticks (16 per box)
- B. "GP" Gun Packs (10 per box)
- C. (6 boxes per case)  
"J" sticks or gun packs

### For Air Operated Lubrication Pumps

- D. 10 lb. Cans (4 per case)
- E. 40 lb. Pails (5 gallons)
- F. 120 lb. Drums (16 gallons)  
55 Gallon Drums (not shown)

### For Screw Prime Guns

- G. "K" Size Sticks (12 per box)
- H. (6 boxes per case)
- I. 1 lb. Cartridges (12 per box)  
(4 boxes per case)

## Melancon No. 90

Multi-purpose Hydrocarbon Valve Lube Sealant. Specially formulated for Natural Gas, LPG, general hydrocarbons, crude oil and aromatics. This product is accepted world-wide for routine valve maintenance on all types of valves, including Plug, Ball & Gate for Rockwell, WKM, Nordstrom, Cameron, Grove, Walworth, FMC & KF brands. **Melancon No. 90** will significantly extend the life of API Gate valves, when it is properly filled in the body cavity.

Temperature Range: - 20° F to 500° F.

## Melancon No. 90 HT

High Temperature Valve Lube Sealant (contains moly-disulfide). Developed for valves in general hot hydrocarbon services. It works well in Natural Gas service for Pipeline valve applications and at Compressor Stations. **Melancon 90 HT** is an excellent Plug valve Lubricant & Sealant for Rockwell, Nordstrom, Walworth, Halliburton Lo-Torque & MSI plug valves. Wellhead API - 6A Gate valves including WKM, Cameron, FMC and Foster.

Temperature Range: - 20° F to 650° F

## Melancon No. 94

Same applications as No. 90. Formulated for easier pumping in cold weather. It has excellent lubricating qualities for routine valve maintenance for all types of valves, including Ball, Plug & Gate type.

Temperature Range: - 20° F to 400° F.

\*All of our Valve Lube Sealants are water insoluble.

List continued on next page



# MELANCON ENERGY PRODUCTS

## Multi-Purpose Valve Lube Sealants

### **Melancon No. 536** Our Premium Grade Routine Valve Maintenance Product (Meets Mil-G-6032) **"Grease Plug Valve, Gasoline & Oil Resistant"**

Multi-purpose Valve Lube Sealant for Natural Gas (wet or dry) Gasoline, Jet Fuel, Aviation Gasoline, Organic Acids & Caustic Solutions. Inhibited for H<sub>2</sub>S & CO<sub>2</sub>. Formulated for Plug, Ball & Gate Valves.  
Temperature Range: - 40° F to 400° F

### **Melancon No. 35**

Valve Lube Sealant for High Pressure CO<sub>2</sub>, Molten Sulphur, Acetic Anhydride & Acetic acid. It also works well in air starting valves.  
Temperature Range: - 50° F to 400° F.

### **Melancon No. 50**

Valve Lube Sealant for Air Starting Valves. Melancon 50 will not polymerize.  
Temperature Range: 0° F to 400° F.

### **Melancon No. 90 G**

Multi-purpose Valve Lube Sealant. Specially formulated for API-6A Gate valve bodies.  
Temperature Range: 0° F to 300° F.

### **Melancon No. 91**

Multi-purpose Hydrocarbon Valve Lube Sealant for Naptha, Kerosene, Ethylene, Butane and Carbon Tetrachloride.  
Temperature Range: - 20° F to 450° F.

### **Melancon No. 95**

Multi-purpose Hydrocarbon Valve Lube Sealant. Designed for Natural Gas, LPG, general hydrocarbons, Crude oil, Gasoline, Propylene, Benzene, Toluene, Butadiene, Xylene, Styrene, Cumene & Aromatics,  
Temperature Range: - 40° F to 300° F.

### **Melancon No. 97** (Premium Grade Routine Plug Valve Maintenance Product)

This Specialty Valve Lube Sealant is formulated with premium base oils & a unique sealing matrix. Services include Natural Gas, LPG, general hydrocarbons & Aromatics. It offers exceptional valve sealing characteristics in plug, ball & gate valve applications. This product is recommended for older valves.  
Temperature Range: - 20° F to 400° F.

### **Melancon No. MP-3**

Multi-purpose EP Bearing Lubricant (petroleum base) Available in cartridges & bulk form.  
Temperature Range: - 20° F to 350° F.

**EMERGENCY and SPECIALTY VALVE LUBE SEALANTS are on pages 4 & 5.**





# MELANCON ENERGY PRODUCTS

## Emergency Valve Lube Sealants

### **Melancon No. 98** (Meets Mil-G-6032 Grease Plug Valve, Gasoline and Oil Resistant)

**EMERGENCY** Valve Lube Sealant specially blended for Natural Gas (wet or dry) gasolines, jet fuel, H<sub>2</sub>S, CO<sub>2</sub>, acids and caustic solutions. It handles a wide range of applications: plug, ball and gate type valves including API-6A wellheads.

Temperature Range: 15° F to 400° F    **Winter Grade:** - 40° F to 300° F

### **Melancon No. 007\* Wonder Seal** (100% Synthetic) Contains NO Teflon® or Solids

**EMERGENCY** Valve Lube Sealant specially formulated for use in plug, ball or gate type valves. It performs extremely well as a sealant on plug, ball or gate valve applications; anywhere valve sealing surfaces have been damaged, including pipeline valves, wellheads, compressor stations & refineries. It has been widely used on pig receiver valves, suction and discharge valves.

**Features:** **Melancon 007** has extraordinary sealing capability for valves with internal seat leakage. It will not dry out or harden in the valve. It contains NO solid fillers and is water insoluble. High Metal Adhesion with inhibitors for H<sub>2</sub>S and excellent corrosion resistance. Suitable for Natural Gas (wet or dry), liquid hydrocarbons, sour gas, crude oil, refined gasolines, distillate and condensate.

Temperature Range: 0° F to 400° F. **Winter Grade:** - 40° F to 400° F

**\*Note:** **Melancon EAGLE 120** series pump is recommended for Melancon 98 or 007 valve sealant injection. (see page 11)  
**Melancon 007** is packaged in 10 lb. cans, 40 lb. pails or 1 lb. cartridges.  
It can also be applied with a **Melancon Model # 62-CT** Screw Type Cartridge Gun. (see page 13)



### **Melancon No. 90 T**

**EMERGENCY** Valve Lube Sealant. Contains Soft Teflon® particles for sealing capability on badly worn or cut valves. **Repeated use is not recommended.**

Temperature Range: - 20° F to 400° F

### **Melancon No. 505 T**

**EMERGENCY** Valve Lube Sealant. Contains heavy matrix of soft Teflon particles for sealing the severist valve seat leakage. All types of Ball, Gate & Plug valves. **Repeated use is not recommended.**

Temperature Range: - 20° F to 375° F



# MELANCON ENERGY PRODUCTS

## Specialty Valve Lubricants & Sealants

### Melancon STG Lubricant Year Round Protection for Gear Boxes

Valve Stem, Thread & Gear Box Lubricant for all types of valves. It can be applied directly onto the teeth of the Bull and Worm gears. (Keeps stem bearings free and retards corrosion)

This product is rated NLGI-2 & EP-2 Grade

**Packaging:** 14.5 oz. cartridges (12 per box) and Bulk forms in 10# cans, 40# pails & 120# drums.

Melancon STG Lubricant is ideal for Routine maintenance on gear boxes for all types of valves & Orbit Ball Valve Stem Bearings.

**Temperature Range:** - 65° F to 360° F



### Melancon No. 45 Specialty Valve Lube Sealant for Lo-Torc Plug Valves (Reduces operating torque)



Developed in 2001, **Melancon 45** has a proven track record...in the field for resolving torque issues, particularly on High Pressure Plug Valves. Specially formulated for use in extremely high pressure plug, ball, or gate valves; Blended to resist a wide range of applications including Hot Distillate / Condensate, Liquid hydrocarbons & fuels, H<sub>2</sub>S and CO<sub>2</sub>. It will substantially reduce the operating torque on close tolerance valves, such as Halliburton Lo-Torc, FMC Weco and MSI LT.

**Temperature Range:** - 40° F to 450° F. Available in stick and bulk forms

### Melancon No. 90 G

Multi-purpose Valve Lube Sealant. Specially formulated for API-6A Wellhead "Expanding" Gate valve bodies. **Melancon 90 G** is blended to protect the internal valve components and your Wellhead valve investments. Our non-abrasive formula will not damage critical down-tube parts in your air operated valve lubrication pumps.

**Melancon 90 G Temperature Range:** 0° F to 300° F **Melancon 90 HT Temperature Range:** - 20° F to 650° F

**NOTE:** Melancon 90HT is recommended for API-6A "Slab" type gate valves such as Cameron F, FC, FL, & FLS series.



Expanding Gate Valve



Slab Gate Valve

### Melancon No. 93 Arctic Grade Extremely low temperature range.

General Hydrocarbon Service, Natural Gas (wet or dry) H<sub>2</sub>S, CO<sub>2</sub> and LNG. For all types of valves.

**Temperature Range:** -70° F to 400° F





# MELANCON ENERGY PRODUCTS

## Ordering Information for Valve Lube Sealants

Size	Sticks / Gun Packs / Cartridges	Per Box
<b>J</b>	8 oz. stick Fits Hydraulic Gun (6 boxes per case)	16
<b>K</b>	10.5 oz. stick Fits Screw Prime Gun (6 boxes per case)	12
<b>GP</b>	8 oz. Gun Packs <b>Note:</b> (Gun Packs are bulk form, injected with model # 14 Hydraulic style guns)	10 Gun Packs
<b>CT</b>	14.5 oz. cartridges used with EE-33-CT & 62-CT (4 boxes per case)	12 Cartridges

Size	Small Sticks	Per Box
<b>B</b>	3/8" x 1-1/2"	24
<b>C</b>	7/16" x 2-1/8"	32
<b>D</b>	1/2" x 2-5/8"	28
<b>G</b>	5/8" x 3-1/2"	13

**Examples:** 90-J, 45-K, 94-GP, 007-CT

## Bulk Forms

- S - Please use this code for bulk forms.

<b>-S- 10</b>	10 lb. cans / 5 qt. (4 cans per case)
<b>-S- 40</b>	40 lb. pail (5 gallon)
<b>-S- 120</b>	120 lb. drum (16 gallons)
<b>-S- 55</b>	55 gallon drum

**Note:** Please specify the product number and packaging preferences.



**Examples:** 90-S-10, 90HT-S-120, 97-S-40, 45-S-10, 007-S-10

**Note:** Information on these Air Operated Valve Lubrication Pumps is located on page 11 of this catalog.

All Melancon products are packaged to fit your existing valve lubrication equipment.

## Valve Lube Sealant Capacity Chart

Plug Valves	
Size	Lube Sealant / Cleaner
1"	1 oz.
1-1/2"	1 oz.
2"	3 oz.
3"	4 oz.
4"	5 oz.
6"	9 oz.
8"	11 oz.
10"	14 oz.
12"	17 oz.
14"	32 oz.
16"	40 oz.
18"	56 oz.
20"	72 oz.
22"	80 oz.
24"	88 oz.
26"	96 oz.
30"	112 oz.

Ball Valves	
Size	Lube Sealant / Cleaner
2"	4 oz.
3"	6 oz.
4"	8 oz.
6"	10 oz.
8"	12 oz.
10"	14 oz.
12"	18 oz.
14"	20 oz.
16"	24 oz.
18"	30 oz.
20"	32 oz.
24"	36 oz.
28"	40 oz.
30"	44 oz.
36"	54 oz.
42"	72 oz.
48"	120 oz.

API-6A Gate Valves (Wellhead Type)	
Bore Size	Lube Sealant / Cleaner
1 - 13/16"	1.5 lbs.
2 - 1/16"	2.0 lbs.
2 - 9/16"	3.2 lbs.
3 - 1/8"	4.6 lbs.
4 - 1/16"	6.0 lbs.
6 - 1/8"	10.0 lbs.
7 - 1/16"	13.0 lbs.

For pipeline style gate valve seats, please refer to the ball valve chart.

Riser Extension Capacities	
Inside Diameter	Ounces Per Foot
1/4"	0.5
3/8"	1.3
1/2"	2.0
3/4"	4.0

**Note:** These charts are merely intended as reasonable guidelines for your valve maintenance requirements. Quantities may vary, depending upon your service conditions and frequency of operation.



# MELANCON ENERGY PRODUCTS

## Valve Cleaner and Valve Purge

**Melancon Valve Cleaner and Valve Purge** are specially formulated to soften and displace hardened deposits including inert solids, lacquer & corrosion deposits, in **all types of valves**, usually within 30 minutes to an hour depending upon the severity of the blockage. Either product is easily applied with a high pressure hydraulic hand gun or an air operated lubrication pump. Then the valve should be cycled several times, if possible. After Valve Cleaner or Valve Purge has freed the valve, simply relubricate your valve with one of our **Melancon Valve Lube Sealants** (refer to Capacity Chart on page 6). They contain no solid fillers.



**Note:** In some severe cases, **Valve Cleaner** may require additional time to soften hardened deposits.

**Valve Cleaner** and **Valve Purge** are safe for all types of valves. These products will **NOT** damage your valve's soft, critical sealing surfaces such as Buna, Viton, Nylon, Teflon, Delrin, Devlon, etc.

**Melancon Valve Cleaner and Valve Purge** will enhance the performance and operation of your plug, ball & gate type valves.

### VALVE CLEANER "Honey Formula"

### Packaging

### Part No.

Poly Bottles	32 oz. bottles (4 per box)	VC - B
	32 oz. bottles (24 per case)	VC - C
Bulk Forms	1 gallon paint style can (4 per case) ( fits Melancon Model 10 – 90 Pump )	VC - 10 - G
	10 lb. can (4 per case) ( used in Hypregun )	VC - 10
	40 lb. pail (5 gallons)	VC - 40
	120 lb. drum (16 gallons)	VC - 120
	55 gallon drum	VC - 55

### VALVE PURGE

Poly Bottles	32 oz. poly bottles (4 per box)	Blue Liquid Formula	VPX - B
	32 oz. poly bottles (24 per case)	Blue Liquid Formula	VPX - C
Gun Packs	10 gun packs per box ( used in Model 14 Hydraulic Gun )	Blue Liquid Formula	VPX - GP
Cartridges	14.5 oz. cartridges (12 per box)	Black Gel	VPX - CT
	14.5 oz. cartridges (4 Boxes per case)	Black Gel	VPX - CT - C
Bulk Forms	1 gallon paint style can (4 per case) ( fits Melancon Model 10 - 90 Pump )	Blue Liquid Formula	VPX - 10 - G
	10 lb. can (4 per case) ( used in Melancon Model 10-90 )	Black Gel	VPX - 10
	40 lb. pail (5 gallon pail) (used in 40-90)	Black Gel	VPX - 40
	120 lb. drum (16 gallons) (used in 120-90)	Black Gel	VPX - 120
	55 gallon drum	Black Gel	VPX - 55





# MELANCON ENERGY PRODUCTS

## Valve Lubrication Fittings

### Giant Button Head Fittings



**D-14**

**D-38**

**D-12**

**D-34**

Part No.	Thread Size
<b>D-14</b>	1/4" NPT
<b>D-38</b>	3/8" NPT
<b>D-12</b>	1/2" NPT
<b>D-34</b>	3/4" NPT
<b>D-1</b>	1" NPT (not pictured)

### Valve Lubrication Fitting Thread Gauge

**1"**

**3/4"**

**1/2"**

**3/8"**

**1/4"**

**1/8"**

### Tall Combination Fittings



**TC-14**

**TC-38**

**TC-12**

**TC-34**

Part No.	Thread Size
<b>TC-14</b>	1/4" NPS
<b>TC-38</b>	3/8" NPS
<b>TC-12</b>	1/2" NPS
<b>TC-34</b>	3/4" NPS

**Note:** All of our Giant Button Head Fittings are Double Ball Check for added safety.

**Note:** For 316 Stainless Steel, simply add - **SS** to the part no.

**Examples:** D-14-SS, TC-38-SS

## MELANCON Fitting Conversion Chart for Lubricated Plug Valves

Valve Size	Rockwell, Nordstrom & Audco		Walworth	
	D - Series	TC - Series	D - Series	TC - Series
1/2" thru 1-1/2"	D-14	TC-14	D-14	TC-14
2" - Fig. 142 & 143	D-14	TC-14	N/A	N/A
2"	D-38	TC-38	D-14	TC-14
2 - 1/2"	D-38	TC-38	D-38	TC-38
3"	D-12	TC-12	D-38	TC-38
4"	D-12	TC-12	D-12	TC-12
6"	D-34	TC-34	D-12	TC-12
8"	D-34	TC-34	D-12	TC-12
10" and larger	D-34	TC-34	D-34	TC-34



# MELANCON ENERGY PRODUCTS

## Capped Fittings, Packing Injectors\* & Couplers



Part No.	Description
<b>C-14</b>	Capped Fitting, 1/4" NPT
<b>C-38</b>	Capped Fitting, 3/8" NPT
<b>C-12</b>	Capped Fitting, 1/2" NPT
<b>C-34</b>	Capped Fitting, 3/4" NPT
<b>Note:</b>	All available in 316 SS & Free Flow design



Part No.	Description
<b>P-12-L</b>	Packing Injector, 1/2" NPT (fits Daniel M & J gate valve)
<b>P-12-LSS</b>	316 SS (Same as above)

For Giant Button Head under the cap, please add - **B** to the part no. **Example:** C-12-BSS.



<b>P-14</b>	Packing Injector, 1/4" NPT
<b>P-38</b>	Packing Injector, 3/8" NPT
<b>P-12</b>	Packing Injector, 1/2" NPT (standard on WKM valves manufactured after 1952)
<b>P-58-C</b>	Packing Injector, 5/8" Coarse Thread (standard on 6" and smaller WKM valves mfg. before 1952)
<b>P-34-C</b>	Packing Injector, 3/4" Coarse Thread (standard on 8" and larger WKM valves mfg. before 1952)



<b>P-14-D</b>	Packing Injector, 1/4" NPT (fits Daniel senior fitting)
<b>P-14-DSS</b>	316 SS (Same as above)

We stock All of the Valve Lubrication Fittings, Capped Fittings, Body Vents & Packing Injectors for Rockwell, Nordstrom, Cameron, Walworth, WKM, Grove, KF, Halliburton, M & J, Orbit, TK, Foster, FMC, MSI & McEvoy brands of valves, as well as others.



<b>P-12-RW</b>	Packing Injector, 1/2" NPT
<b>P-34-RW</b>	Packing Injector, 3/4" NPT (fits most Hypreaseal plug valves)

**Note:** For 316 Stainless Steel, simply add - **SS** to the part no. **Examples:** C-12-SS, P-12-SS.  
For Free Flow style fittings, please add - **FF** to the part no. **Examples:** C-12-BSS-FF, P-12-SS-FF

\*Melancon Model # 14-P Hydraulic Packing Gun is on page 14.



**2-GBC** Giant Button Head Coupler, 1/4" NPT with Nylon washer.  
(standard on Melancon Model # 14)



**4-SBC** Standard Button Head Coupler, 1/8" NPT with rubber washer.  
**Note:** CAM-2 Safety Adapter is recommended for old style Cameron ball valves.



**3-GBC** Giant Button Head Coupler, 1/4" NPT with Steel washer & pressure release.  
(standard on Model # 62-WGL & 62-CT)



**5-GBC** Giant Button Head Coupler, 1/4" NPT with Steel shut-off washer.



# MELANCON ENERGY PRODUCTS

## Valve Lubrication Safety Adapters, Body Vents & Tools

Part No. Description



**W-2**

Safety Adapter for WKM, Grove & KF style fittings with by-pass and check. Also fits Mc Evoy seat fittings. All Cameron Ball valves mfg. after 1980.

**W-2-SP**

Safety Adapter for Old Style WKM fittings w/ short thread (not pictured)



**CAM-2**

Safety Adapter for old style Cameron ball valves with by-pass and check.



**PR-12**

Pressure Releasing Tool

**VLAK**

Valve Lubrication Adapter Kit Complete with W-2 & CAM-2 Kit, Safety Adapters, PR-12 Pressure Releasing Tool, PB-1 Piggy Back Fitting and PKR-20 Packing Releasing Tool



Part No. Description



**BV-12-DSS**

Bleeder Valve, 1/2" NPT, 316 SS (standard on Daniel senior fittings and SPX gate valves - Formerly Daniel M & J)



**B-12**

Body Vent Fitting, 1/2" NPT (also available in 1/4", 3/8", 3/4" & 1"NPT) add -SS for 316 SS



**PB-1**

Piggy Back Fitting - Can be used when Giant Button Head Fitting cannot be safely removed.



**MC-1**

McEvoy Body Adapter

### Valve Safety Tips & Suggestions

- Always wear your P.P.E. (Personal Protection Equipment)
- Before pressuring up, inspect ALL of the fittings on the valve (they are your Lifeline to the valve)
- Always relieve pressure Before disengaging from the valve. (watch the gauge fall to Zero & use the hose to disconnect)
- Never assume any valve has a "working" buried ball check.
- Watch your Gauge during valve maintenance procedures. (the gauge is your "eyes and ears" inside the valve)
- Use the appropriate Equipment, Safety Adapters and Tools.

Melancon offers Valve Safety & Maintenance Training Classes.



# MELANCON ENERGY PRODUCTS

## Air Operated Valve Lubrication Pumps

### Model # 10-90 Features:

- 90:1 Ratio Industrial Lubrication Pump
- Rated up to 10,000 psi
- Delivery: 1/10 ounce per stroke
- 10' or 20' / 20,000 psi minimum burst pressure grease hose, 15,000 psi gauge, swivels, RV-14 shutoff valve w/ pressure release or metal seated valve
- Whip end hose, solid steel tee and giant button head coupler
- Spring loaded follower plate for positive priming
- Heavy Duty rust resistant aluminum canister with dolly and 10" inflated rubber wheels

— To load, simply insert a 10 lb. can into the canister.  
Overall dimensions: 40" height x 22" width  
Approximate weight: 62 lbs.

### Model # 10-90



### Model # 40-90



The **Melancon Model # 40-90** holds a 40 lb. pail (5 gallons). It is equipped with our 90:1 ratio industrial pump, a heavy duty canister, 10' or 20' hose with swivels, giant button head coupler, gauge, RV-14 shutoff valve with pressure release, dolly, a spring loaded follower plate & 10" inflated rubber wheels (pictured above with a 20' hose).

— To load, simply insert a 40 lb. pail into the canister.  
Overall dimensions: 39" height x 23" width  
Approximate weight: 70 lbs.

**Note:** The above air operated valve lubrication pumps release up to 9,000 psi with only 100 psi inlet air supply, while delivering 1/10 ounce per stroke. Each unit is specifically designed to save time, significantly reduce maintenance costs and extend valve life.

**Note:** Model # 120-80 shown on page 13

## EAGLE Model # E120

### Features: Rated up to 15,000 psi

- 120:1 Ratio Industrial Pump
- Large Volume Delivery: 1/2 ounce per stroke
- 5" Air Motor: Product injected on both strokes
- Dual Pneumatic Cylinders
- Durable, Heavy Duty Construction
- Adjustable discharge pressure: Up to 15,000 psi
- 10' High Pressure Hose Assembly Complete with Hose, Swivels, 15,000 or 20,000 psi Gauge, Whip End Hose, Giant Button Head Coupler with Pressure Release and Control Valve or RV-14
- Oiler, Filter & Regulator w/ gauge included
- Heavy Duty Protective Bracket for Regulator / Filter
- Dual Follower Plate for 10 lb. can or 40 lb. pails
- Adjustable air motor relief valve for added safety
- Maximum air inlet pressure: 125 psi
- Rams are permanently lubricated
- Pumps up to 5 lbs. per minute of NLGI # 2 grease
- Ideal for pumping viscous sealants such as:

**Melancon No. 007, 45, 90T, 98**

**Note:** Our standard **E120 Pump** is rated at 10,000 psi. Please specify part no. **E120-15M** for 15,000 psi pump.







# MELANCON ENERGY PRODUCTS

## High Pressure Valve Lubrication Guns

### Model # 14 - Hydraulic\*

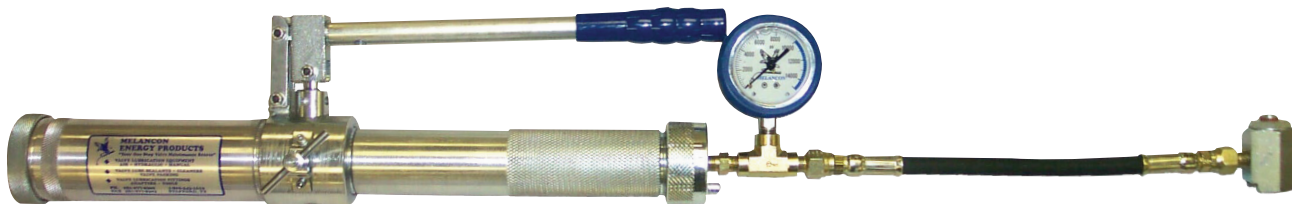

The **Melancon Model 14** Valve Lubrication Gun provides up to 10,000 psi. Constructed from heavy duty steel, it weighs 18 lbs. and delivers approximately 1/44 oz. per stroke. Special features include a built-in internal relief valve for maximum safety and a by-pass valve. This unit is equipped with a 15,000 psi liquid filled gauge with protective cover, hose, swivel, giant button head coupler and solid steel tee. It performs best with a "J" size stick. (16 sticks per box, 6 boxes per case).

### Model # 1442 Hydra Case - Protective Carrying Case Only

\***Model # 14-CC** Hydraulic Gun Complete with Hydra Case

\***Model # 14-CC - SP** Hydraulic Gun Complete with Hydra Case & Adapters

Pictured here  
Model # 14-CC - SP

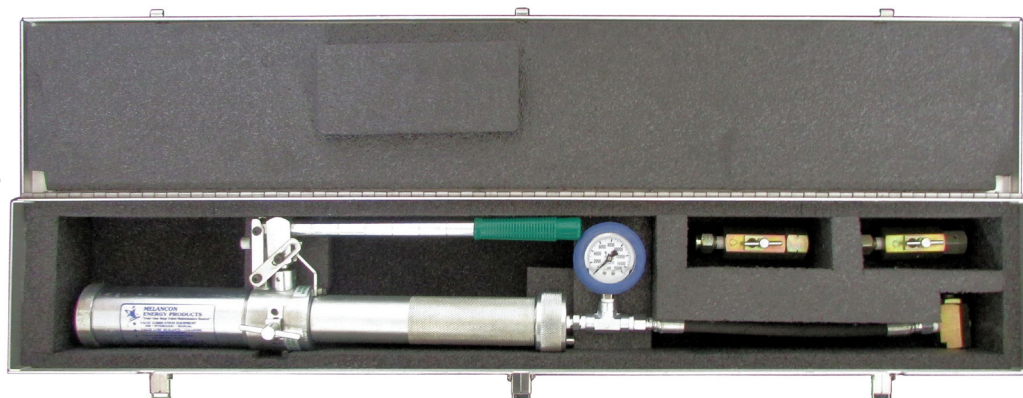

The **Melancon "Hydra Case"** is designed to protect one Model 14 Hydraulic grease gun. Product features include spare compartments to hold safety adapters, tools, & additional fittings. A heavy-duty foam padded insert for extra protection, as well as stainless steel latches & hinges. The **"Hydra Case"** is made of durable, lightweight aluminum. The **Model 1442** will significantly prolong the life of your hydraulic grease gun investment.

### Model # 14-REM Hydraulic – Exchange

Trade in an old hydraulic gun for a **Model 14-REM** remanufactured gun. Completely rebuilt, replated and tested, it is an economical alternative to a new gun.

**All major brands are accepted for exchange, as parts are interchangeable. Please include the hose assembly for a safety inspection and pressure test.**

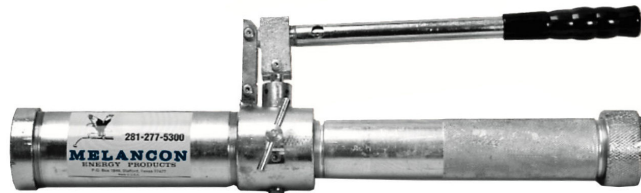

**Note:** For prolonged gun life, avoid carrying hydraulic guns by the handle and try to keep the by-pass valve in the closed position, except when loading the gun or relieving pressure.



# MELANCON ENERGY PRODUCTS

Manual Operated - Screw Prime Type

## Model # 62 - WGL High Pressure Valve Lubrication Gun

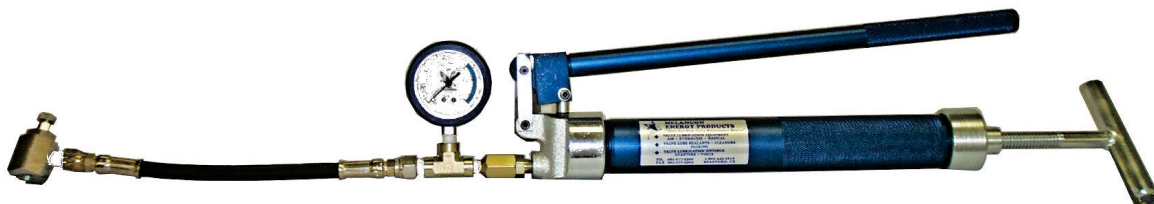

The **Melancon Model # 62-WGL** is a lightweight, high pressure valve lubrication gun. It builds 12,000 psi or more with little effort. Completely equipped with a high pressure hose assembly including 15,000 psi gauge with cover, swivel, giant button head coupler with pressure release, solid steel tee & check valve. Fully loaded, this gun weighs only 11 lbs. It has a heavy-duty aluminum barrel and uses a "K" size stick (12 sticks per box, 6 boxes per case). It delivers approximately 1/16 oz. per stroke. These are very reliable and dependable units.

## Model # 62 - CT High Pressure Valve Lubrication Gun



**NOTE:** The **Melancon Model # 62-CT** is used with 14.5 to 16 oz. Cartridges (Standard Size) of Valve Lubricant, Sealant, Valve Purge or EMERGENCY Valve Sealants.

## Model # 120-80

### Air Operated Valve Lubrication Pump



The **Melancon Model # 120-80** is ideal for large valve lubrication jobs & maintenance of wellhead gate valves where large quantities of valve lubricant / cleaner are required. It mounts easily on a 120 lb. drum, which reduces reloading time. It comes complete with our 90:1 ratio industrial pump, heavy duty drum cover, a 10' or 20' high pressure grease hose, swivels, 15,000 psi gauge, control valve or RV-14 with pressure release, follower plate & W-2 safety adapter. A giant button head coupler is included for plug and ball valve maintenance.

## Model # 67

### Hand Operated Bucket Pump



The **Melancon Model # 67** is a rugged 15,000 psi Bucket Pump. It is ideal for valve lubrication in the field, when an air supply is not available. Equipped with a 15,000 psi hand pump, canister, 10' grease hose, 15,000 psi liquid filled gauge with cover, swivels, spring loaded follower plate, pressure release and W-2 safety adapter for safe valve lube sealant injection. A giant button head coupler is included. It delivers approximately 1/16 oz. per stroke. For best results, we recommend a 10 lb. can or bulk loading the canister from a 5 gallon pail. Fully loaded, this unit weighs approximately 35 lbs.

**Note:** Please specify a soft, bulk grade product, when ordering valve lube sealant for use with this pump.

**Examples:** 90HT-S-40, 94-S-40





# MELANCON ENERGY PRODUCTS

## Battery Powered Valve Lubrication Pump “**ELECTRIC EAGLE**” **EE-33-CT\*** *for Cartridges*



### Complete with:

1. 20 Volt Battery Powered, Hand-Held Valve Lubrication Pump
2. 15,000 psi Gauge, Solid Steel Tee with Giant Button Head Coupler
3. 14" High Pressure Grease Hose (20,000 psi minimum burst pressure)
4. RV-14 Combination Shut-Off & Relief valve
5. 20 Volt, 4 Amp Rechargeable Batteries (2 each)
6. Battery Charger
7. Protective Carrying Case

### Standard features:

1. LCD screen displaying battery life, grease capacity, ounces or grams dispensed.  
The screen turns **Red**, when the barrel is empty.
2. Flow Rates: 4 ounces per minute OR 6 ounces per minute.

The **EE-33-CT\*** Electric Eagle has a One year Limited Warranty

Note: This product is not intrinsically safe. Damaged or cracked batteries are unsafe to charge and must be recycled properly. Do not use other manufacturers batteries.



# MELANCON ENERGY PRODUCTS

## Multi-Purpose Valve Stem Packing for All Types of Valves

**Tiger Pak** is injection type packing with a high Teflon® content. It is blended with a solvent resistant synthetic oil and selected anti-extrusion fibers. This matrix is formulated to energize valve stem packing glands and stop packing leaks. It is applicable for Natural Gas (dry or wet), Crude Oil, H<sub>2</sub>S, CO<sub>2</sub>, Steam, Distillate, Glycols, Dilute Acids and Aqueous Solutions.

Temperature Range: - 85° F to 600° F (Color - **Blue**)

**Tiger Pak "F"** is specially formulated for Unleaded Gasoline, MTBE, Diesel Fuel (all grades), Jet Fuel, Ethylene, Propylene, Butadiene, Liquid Hydrocarbons, Distillate, LPG and Natural Gas (wet or dry).

Temperature Range: - 20° F to 400° F (Color - **Green**)



**NOTE:** **Tiger Pak**, **Tiger Pak "F"** and **Tiger Pak "A"** Valve Stem Packing is widely accepted for WKM, Orbit, M & J, OFM, Nordstrom, Rockwell, Walworth, McEvoy and Foster valves, to name a few.

**Tiger Pak "A"** is specially formulated for Ammonia Service, Water, Steam, most Dilute Acids except Hydrofluoric Acid. Also suitable for Alkalies and Alcohols including 100% Ethanol. Temperature Range: - 50° F to 350° F (Color- **Brown**)

**Tiger Pak "A"** is Not Suitable for Hydrocarbon Liquids, LPG, Crude Oil, Kerosene and Gasoline.

**NOTE:** All of the above packing products are 100% asbestos free.

Part No.	Size	Packaging
TP - 2	1-1/2" x 7"	2 sticks per Box
TP - 100	3/8" x 1"	100 sticks per Jar
TPF - 2	1-1/2" x 7"	2 sticks per Box
TPF - 100	3/8" x 1"	100 sticks per Jar
TPA - 100	1-1/2" x 7"	2 sticks per Box
TPA - 2	3/8" x 1"	100 sticks per Jar

## Model # 14-P Hydraulic Packing Gun and Packing Adapters



The **Melancon Model 14-P Hydraulic Packing Gun** is a simple way to stop valve stem packing leaks. It delivers approximately 1/44 oz. per stroke. Standard equipment includes a 15,000 psi gauge with cover, solid steel tee, 3/8" NPT swivel / hose and a PA-20 (standard WKM style packing adapter). It holds one large packing stick and has a conical packing barrel cap.



Part No.	Description
<b>PA-20</b>	WKM-style packing adapter (standard on Model 14-P and fits most packing injectors)
<b>PA-20-B</b>	Daniel Senior Fitting Adapter with giant button head fitting (pictured on page 16)



<b>PA-20-MJ</b>	M & J style packing adapter (fits Daniel M & J gate valve)
-----------------	---



Part No.	Description
<b>PA-716</b>	Orbit style packing adapter (special small thread size for small Orbit ball valves)



<b>PKR-20</b>	Packing Releasing Tool (fits most packing injectors)
---------------	---



# MELANCON ENERGY PRODUCTS

## Spare Parts

### 12-HC Complete Hose Assembly



Part No.	Description
<b>12-HC</b>	Hose Assembly Complete with 15,000 psi Gauge w/ cover, Swivel-Hose, Giant Button Head Coupler & Solid Steel Tee. (standard on Melancon model # 14 Hydraulic Lubrication Gun)
<b>15-G</b>	Gauge, 15,000 psi, 316 SS Liquid Filled , 1/4" NPT with Protective Cover
<b>2-GBC</b>	Giant Button Head Coupler, 1/4" NPT with nylon washer. (also shown on page 9)
<b>12-HS</b>	Hose Center Only with 1/4" NPT male swivel ends. 14" is standard. 18" or longer lengths available)
<b>HT-14</b>	High Pressure Solid Steel Tee, 1/4" NPT, 15,000 psi
<b>301296</b>	Adapter, 1/4" NPT Male
<b>301296-L</b>	Adapter, 1/4" NPT Male (special length: for use with Gun Packs in model # 14 Hydraulic gun, not pictured).

### Small Lubrication Fittings and Parts



**5-NW**



**Z-18**



**Z-14**



**SB-18**



**SB-14**

Part No.	Description
<b>5-NW</b>	Nylon Coupler Washer (for use in 2-GBC giant button head coupler)
<b>Z -18</b>	Zerk Fitting, 1/8" NPT, (generally used for stem bearing lubrication)
<b>Z -14</b>	Zerk Fitting, 1/4" NPT, (commonly used for stem bearing & gear box lubrication)
<b>SB -18</b>	Standard Button Head Fitting, 1/8" NPT (single check)
<b>SB -14</b>	Standard Button Head Fitting, 1/4" NPT (single check) <b>Note:</b> All of our Z and SB series fittings are available in 316 SS.
<b>3 - GBC</b>	Giant Button Head Coupler with Steel Washer & Pressure Release (standard on model # 62-WGL & 62-CT Screw type grease guns) (pictured on page 9)
<b>4 - SBC</b>	Standard Button Head Coupler, 1/8" NPT female, (pictured on page 9)
<b>5 - GBC</b>	Giant Button Head Coupler with Shut-off Washer, (pictured on page 9)
<b>14875</b>	Fluid Bag Assembly for Model # 14 Hydraulic Lubrication gun.
<b>Hyd - Oil</b>	Hydraulic Oil for Model # 14 gun, in 1 quart poly bottles.
<b>DG-100</b>	Degreaser, Environmentally Safe. Shown on page 36.
<b>ESPEN Oil</b>	Environmentally Safe Penetrating Oil in 16 oz. spray cans, 1 gallon, 5 gallon, see page 36.

**Note:** Giant button head fittings are shown on page 8.  
Capped style fittings & Packing Injectors are on page 9.  
Additional parts are available for all of our hydraulic, manual and air operated valve lubrication pumps.



# MELANCON ENERGY PRODUCTS

## In-Line Check Valves 6000 psi - 316 SS



Part No.	Size
ICV-14-SS	1/4" NPT
ICV-38-SS	3/8" NPT
ICV-12-SS	1/2" NPT
ICV-34-SS	3/4" NPT
ICV-1-SS	1" NPT

**NOTE:** Viton Seal standard (optional Buna Seal is included)

## Adjustment Screws & Caps for Hypreseal Plug Valves



**AS-2**



**ASC-2**

Valve Size	Adjustment Screw	Adjustment Screw Cap
1/2" & 1"	<b>AS - 1</b>	<b>ASC - 1</b>
1-1/2"	<b>AS - 112</b>	<b>ASC - 112</b>
2"	<b>AS - 2</b>	<b>ASC - 2</b>
3"	<b>AS - 3</b>	<b>ASC - 3</b>
4"	<b>AS - 4</b>	<b>ASC - 4</b>
6"	<b>AS - 6</b>	<b>ASC - 6</b>
8"	<b>AS - 8</b>	<b>ASC - 8</b>
10"	<b>AS - 10</b>	<b>ASC - 10</b>

Avoid potentially dangerous situations. Replace rusted or damaged Adjustment Screws and Caps. Larger sizes available upon request.



**A**



**B**



**C**



**D**



**E**

## Senior Orifice Fitting Products

- A. P-14-DSS** Lubricant / Sealant Injector, 1/4" NPT, 316 SS
- B. PA-20-B** Senior Fitting Injector Adapter w/ Giant Button Head
- C. Daniel Type 1 Lubricant** Senior Fitting Lubricant / Sealant, 24 sticks per box
- D. BV-12-DSS** Bleed Valve Assembly, 1/2" NPT, 316 SS
- E. EV-78-DSS** Equalizer Valve Assembly, 316 SS
- F. VC-SF-B** Valve Cleaner for Senior Fittings in 32 oz. poly bottles, 4 per box ([see page 7](#))

**Note:** VC-SF-B can be applied w/ a [Melancon Model # 14](#) Hydraulic Gun





# MELANCON ENERGY PRODUCTS

## Valve Safety & Maintenance Training, Consulting and Valve Repair

**Valve Safety and Maintenance Training:** Instructor with over **43 Years** Field Experience

**Valve Consulting:** for Plug, Ball and Gate Valves

**Valve Maintenance and Troubleshooting Service:** by Certified Technicians

---

### Valve Repair and Testing

Every valve is Completely:

1. Disassembled
2. Cleaned
3. Components Inspected
4. Machine Shop Process (minor welding limited to Flange faces)
5. Reassembled including soft goods, packing, seat inserts, seals & gaskets.
6. Seats, Parts and Fittings are replaced as needed
7. Hydrostatic Test (**Body Shell and Seat**) with Documentation: per API-6D or API-6A.
8. Re-painted
9. Valves prepared for Shipment with Test Reports included.

### Valve Types



#### Plug:

We repair all ANSI classes of Steel, Cast Iron, Regular Port or Venturi, including Rockwell, Walworth and Nordstrom. Straight Pattern and Multiport lubricated plug valves. **All major brands.** API-6A Lo-Torque valves, 5000 and 10,000 psi



#### Ball:

Carbon, Stainless, ANSI, API-6D, NACE, Full or Reduced Port, Trunnion Mounted or Floating Ball. All major brands.

**Note:** New Ball Valves are on pages **18-25**

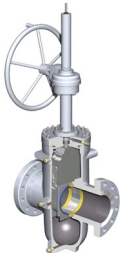

#### Gate:

Carbon, Stainless, ANSI, Wedge Gate, Slab Gate, Pipeline style Expanding Gate, API-6D, Thru/Conduit, API-6A Wellhead type

**Note:** New API-6A Wellhead Gate Valves are on page **27**.



#### Orbit:

Carbon, Stainless and Special Alloy for all services - API-6D



#### Check:

Swing Checks or Piston Style,  
Cast Iron, Carbon, Stainless, Soft or Metal Seat

**Special Alloy:** Monel, Hastelloy, Nickel and Inconel for all types of valves.



# MELANCON ENERGY PRODUCTS

## Ball Valves

### M78SW Series - 2000 PSI Full Port

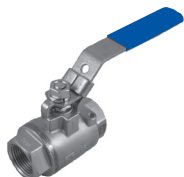

#### Standard Features:

Sizes: 1/4" – 2" NPTF  
Available in 316 SS or C/S w/ 316 SS ball & stem,  
Lever Locking Handle, NACE & Welded End  
Reinforced Teflon® Seats.

[Complete specifications on page 19](#)

### Common Dimensions

#### M78SW Series - 2000 psi

Valve Size	PSI Rating	Valve Length	Valve* Bore	Weight in lbs.
1/4"	2000	2.09	.45	.70
3/8"	2000	2.09	.50	.70
1/2"	2000	2.36	.50	.65
3/4"	2000	2.80	.78	1.15
1"	2000	3.23	.98	2.20
1-1/4"	2000	3.62	1.25	4.00
1-1/2"	2000	4.06	1.50	5.00
2"	2000	4.65	1.96	8.20

### M78SW3 Series - 3600 PSI Full Port



Sizes: 1/4" – 2" NPTF  
3600 psi, ANSI Class 1500, 316 SS or CS x SS  
B16.34, API-607 Fire Safe, NACE, Lever Locking  
handle, Delrin Seats, Welded End for added safety

[Complete specifications on page 20](#)

6000 psi, ANSI Class 2500. **M78SW6** on page 21

#### M78SW3 Series - 3600 psi

Valve Size	PSI Rating	Valve Length	Valve Bore	Weight in lbs.
1/4"	3600	3.00	.39	1.58
1/2"	3600	4.00	.50	1.84
3/4"	3600	4.30	.75	3.05
1"	3600	4.80	1.00	5.26
1-1/2"	3600	5.30	1.50	10.60
2"	3600	6.30	1.50	13.00

### M325 Series - Reduced Port M525 Series - Full Port



Sizes: 1/4" – 2" NPTF Threaded or Socket Weld Ends  
3 Piece Bolted Body (8 enclosed bolts)  
In-Line Maintainable (parts are readily available)  
316 SS or C/S Body A105 w/ 316 SS ball & stem  
Forged Steel Construction  
Optional Oval Safety Handle, Fire Safe

Standard ratings are 2000 psi with 3000 psi available

**Note:** The M525 chart is available upon request.

#### M325 Series

Valve Size	PSI Rating	Valve Length	Valve Bore	Weight in lbs.
1/4"	2000 3000	2.56	.43	1.3
3/8"	2000 3000	2.56	.43	1.3
1/2"	2000 3000	2.56	.43	1.3
3/4"	2000 3000	2.78	.55	2.3
1"	2000 3000	3.69	.89	2.3
1-1/4"	2000 3000	4.19	1.14	7.5
1-1/2"	2000 3000	4.53	1.14	7.0
2"	2000 3000	4.97	1.50	12.7

### M79 Series - Full Port



Sizes: 1/4" – 2"  
Self Contained Body w/ Double Union Ends  
In-Line Maintainable, Bi-Directional Flow  
Full Port thru 1-1/2", nearly full port 2"  
Available in 316 SS or C/S with 316 SS Trim  
Threaded, Socket Weld or Butt Weld Ends  
Ratings up to 4500 psi (2000 or 3000 psi standard)

#### M79 Series Full Port (2" is 1.72 orifice)

Valve Size	PSI Rating	Valve Length	Valve Bore	Weight in lbs.
1/4"	Up to 4500	3.93	.44	2.5
3/8"	Up to 4500	3.93	.58	2.4
1/2"	Up to 4500	3.93	.66	2.4
3/4"	Up to 4500	4.50	.81	3.3
1"	Up to 4500	4.93	1.00	5.2
1-1/4"	Up to 4500	5.37	1.23	7.2
1-1/2"	Up to 4500	5.87	1.44	9.6
2"	Up to 4500	6.87	1.72	15.4

### DM Series - Full Port or Reduced Port



Sizes: 1/4" – 4" NPTF  
6,000 or 10,000 psi rated  
Heavy Duty Construction  
Available in 316 SS or C/S  
Wide range of connections - NPTF,  
SAE-F ORB, ISO6149,  
ISO1179, BSPP-F

#### DM Series Full Port

Valve Size	Part Number	PSI Rating	Valve Length	Valve Bore	Weight in lbs.
1/4"	DM14-6FP	6000	2.74	.25	1.50
3/8"	DM38-6FP	6000	2.87	.38	2.00
1/2"	DM12-6FP	6000	3.35	.50	2.00
3/4"	DM34-6FP	6000	3.80	.75	5.00
1"	DM1-6FP	6000	4.49	1.00	5.00
1-1/4"	DM114-6FP	6000	4.84	1.25	8.50
1-1/2"	DM112-6FP	6000	5.33	1.50	11.50
2"	DM2-6FP	6000	6.54	2.00	19.00
2-1/2"	DM212-6FP	6000	7.50	2.50	54.00
3"	DM3-6FP	6000	9.28	3.00	94.00
4"	DM4-6FP	6000	11.21	4.00	160.00

**Note:** For 316 SS add **S** to the part no.  
For 10,000 psi valves: Change the 6 to **10**  
**Example:** DM12-10FPS







## MELANCON BALL VALVES

### FULL Port - M78SW Series

**2000 psi, WOG, 316 S.S.**

*\* Welded End for Added Safety*

*The valve body CANNOT be unscrewed.*



**Sizes: 1/4" - 2" In Stock**

### Standard Features

1. 2000 psi, WOG Rating on CF8M  
Valves also available in 3600 & 6000 psi.
2. FULL Port, 2" Almost Full (1.96" Port)
- \* 3. Welded End for Added Safety
4. NACE MR-0175 Compliant
5. Mounting Pad for Actuator
6. Lever Locking Handle
7. Blow - Out Proof Stem, Floating Ball

Parts	Material
1. BODY	ASTM A351-CF8M/1.4408 (316 SS)
2. CAP	ASTM A351-CF8M/1.4408 (316 SS)
3. BALL	ASTM A351-CF8M (316 SS)
4. STEM	ASTM A276-(316 SS)
5. GLAND NUT	304 SS
6. BALL SEAT	PTFE / RPTFE
7. BODY SEAL	PTFE
8. PACKING	PTFE / RPTFE
9. THRUST WASHER	PTFE
10. SPRING WASHER	304 SS
11. STEM NUT	304 SS
12. HANDLE	304 SS
13. HANDLE SLEEVE	PVC
14. LOCKING DEVICE	304 SS

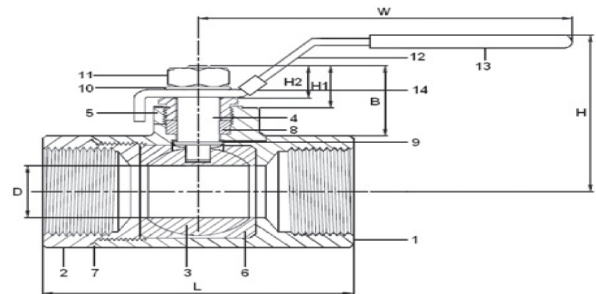
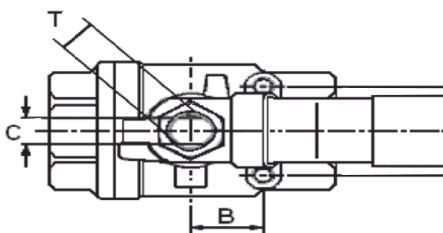

Size	MELANCON	D	L	H	H1	H2	W	S	B	C	T	Torque	Weight
1/4" FP	M14-78SW	0.4500	2.25	1.9685	0.9843	0.4331	3.937	1.1024	0.5512	0.1969	0.3071	22.13	0.70
3/8" FP	M38-78SW	0.5000	2.25	1.9685	0.9843	0.4331	3.937	1.1024	0.5512	0.1969	0.3071	22.13	0.70
1/2" FP	M12-78SW	0.5	2.51	1.9685	0.9843	0.4331	3.937	1.1024	0.5512	0.1969	0.3071	26.55	1.15
3/4" FP	M34-78SW	0.7874	2.95	2.3622	1.2402	0.6299	4.921	1.3780	0.8661	0.2559	0.3071	44.25	1.75
1" FP	M1-78SW	0.9843	3.55	2.7559	1.4370	0.7087	6.299	1.3780	0.8661	0.3150	0.4252	61.95	2.20
1-1/4" FP	M114-78SW	1.2598	4.02	3.1496	1.4370	0.7087	6.299	1.4961	0.9449	0.3150	0.4252	88.51	4.00
1-1/2" FP	M112-78SW	1.4961	4.55	3.5433	1.6732	0.8071	7.480	1.4961	0.9449	0.3543	0.4921	132.76	5.00
2" RP	M2-78SW	1.96	5.41	3.5433	1.6732	0.7283	7.480	1.4961	0.9449	0.3543	0.4921	177.01	8.20



## MELANCON BALL VALVES

### FULL Port - M78SW3 Series

\* 3600 psi, WOG, 316 S.S.

Welded End for Added Safety

The valve body **CANNOT** be unscrewed.



\* 3705 psi, WOG, WCB Carbon Steel Sizes: 1/4" - 2" In Stock  
WCB with 316 S.S. Ball & Stem

### Standard Features

1. Wall thickness according to ASME B16.34, ANSI Class 1500
2. 3600 psi, WOG Rating on 316 SS (CF8M)  
\* 3705 psi, WOG Rating on Carbon Steel
3. NACE MR-0175 Compliant
4. Fire Safe tested to API 607, 5th Edition
5. ISO 5211 Mounting Pad for Actuator
6. Lever Locking Handle
7. Blow - Out Proof Stem, Floating Ball
8. Tested to API 598
- \* 9. Welded End for Added Safety
- \* 10. Valves also available in 2000 & 6000 psi.

Parts	Material
1. BODY	CF8M or WCB
2. CAP	CF8M or WCB
3. BALL	CF8M
4. BALL SEAT	3600 DELRIN / 6000 PEEK
5. JOINT GASKET	GRAPHITE
6. STEM	316 S.S. or 17- 4 PH (1-1/2", 2")
7. THRUST WASHER	DELIN
8. STEM PACKING	GRAPHITE
9. GLAND NUT	304 S.S.
10. SPRING WASHER	304 S.S.
11. STEM NUT	304 S.S.
12. HANDLE	304 S.S.
13. LOCKING DEVICE	304 S.S.
14. HANDLE COVER	PLASTIC

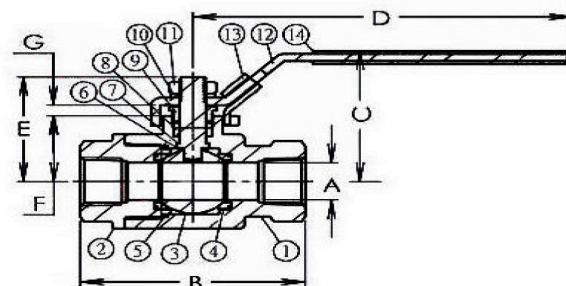
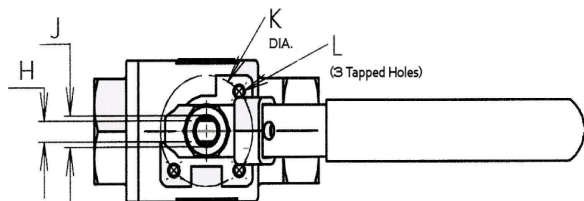

SIZE	MELANCON	A	B	C	D	E	F	G	H	J	K	L	ISO 5211	Weight	Cv	Max Torque
1/4" FP	M14 - 78SW3	0.25	3	2.22	5	1.64	1	0.18	0.195	0.311	1.42	1/4-20 UNC	F03	1.58	10	75 in - lbs
3/8" FP	M38 - 78SW3	0.38	4	2.23	5	1.64	1	0.18	0.195	0.311	1.42	1/4-20 UNC	F03	1.71	14	75 in - lbs
1/2" FP	M12 - 78SW3	0.50	4	2.22	5	1.64	1	0.18	0.195	0.311	1.42	1/4-20 UNC	F03	1.84	16	75 in - lbs
3/4" FP	M34 - 78SW3	0.75	4.3	2.89	5.83	2.13	1.32	0.21	0.274	0.436	1.65	1/4-20 UNC	F04	3.05	32	120 in - lbs
1" FP	M1 - 78SW3	1.00	4.8	3.50	8.19	2.81	1.76	0.28	0.374	0.559	1.97	1/4-20 UNC	F05	5.26	62	400 in - lbs
1-1/2" FP	M112-78SW3	1.50	5.3	4.34	10.2	3.85	2.5	0.34	0.392	0.623	2.76	5/16-18 UNC	F07	10.60	140	750 in - lbs
2" RP	M2 - 78SW3	1.50	6.3	4.34	10.2	3.85	2.5	0.34	0.392	0.623	2.76	5/16-18 UNC	F07	13.00	120	750 in - lbs



## MELANCON BALL VALVES

### FULL Port - M78SW6 Series

- \* **6000 psi, WOG, 316 S.S.**  
**Welded End for Added Safety**  
**The valve body CANNOT be unscrewed.**



- \* **6170 psi, WOG, WCB, Carbon Steel**  
**WCB with 316 S.S. Ball & Stem**

Sizes: **1/4" - 2"** **In Stock**

### Standard Features

1. Wall thickness according to ASME B16.34, ANSI Class 2500
2. **6000 psi, WOG Rating on 316 SS (CF8M)**  
\* 6170 psi, WOG Rating on Carbon Steel
3. **NACE MR-0175 Compliant**
4. **Fire Safe** tested to API 607, 5th Edition
5. ISO 5211 Mounting Pad for Actuator
6. Lever Locking Handle
7. Blow - Out Proof Stem, Floating Ball
8. Tested to API 598
- \* 9. **Welded End for Added Safety**
- \* 10. 2000 psi & 3600 psi valves also in STOCK.

Parts	Material
1. BODY	CF8M or WCB
2. CAP	CF8M or WCB
3. BALL	CF8M
4. BALL SEAT	3600 DELRIN / 6000 PEEK
5. JOINT GASKET	GRAPHITE
6. STEM	316 S.S. or 17- 4 PH (1-1/2", 2")
7. THRUST WASHER	PEEK
8. STEM PACKING	GRAPHITE
9. GLAND NUT	304 S.S.
10. SPRING WASHER	304 S.S.
11. STEM NUT	304 S.S.
12. HANDLE	304 S.S.
13. LOCKING DEVICE	304 S.S.
14. HANDLE COVER	PLASTIC

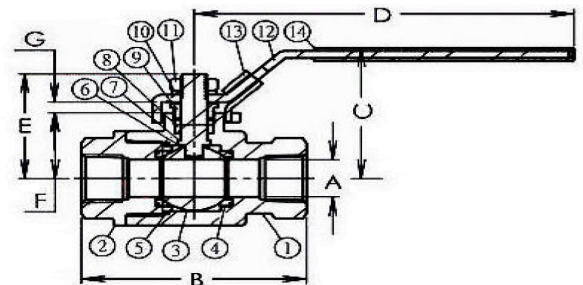
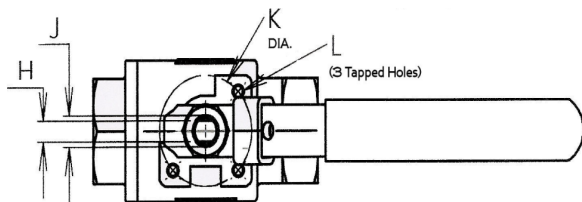

SIZE	MELANCON	A	B	C	D	E	F	G	H	J	K	L	ISO 5211	Weight	Cv	Max Torque
1/4" FP	M14 - 78SW6	0.39	4.37	2.22	5	1.64	1	0.18	0.195	0.311	1.42	1/4-20 UNC	F03	1.58	10	100 in - lbs
3/8" FP	M38 - 78SW6	0.47	4.37	2.23	5	1.64	1	0.18	0.195	0.311	1.42	1/4-20 UNC	F03	1.71	14	100 in - lbs
1/2" FP	M12 - 78SW6	0.50	4.37	2.22	5	1.64	1	0.18	0.195	0.311	1.42	1/4-20 UNC	F03	2.38	16	140 in - lbs
3/4" FP	M34 - 78SW6	0.75	4.37	2.89	5.83	2.13	1.32	0.21	0.274	0.436	1.65	1/4-20 UNC	F04	3.81	32	270 in - lbs
1" FP	M1 - 78SW6	1.00	5.39	3.50	8.19	2.81	1.76	0.28	0.374	0.559	1.97	1/4-20 UNC	F05	6.73	62	700 in - lbs
1-1/2" FP	M112-78SW6	1.50	6.3	4.34	10.2	3.85	2.5	0.34	0.392	0.623	2.76	5/16-18 UNC	F07	14.58	140	1200 in-lbs
2" RP	M2 - 78SW6	1.50	6.3	4.34	10.2	3.85	2.5	0.34	0.392	0.623	2.76	5/16-18 UNC	F07	18.06	120	1200 in-lbs



# MELANCON ENERGY PRODUCTS

## Ordering Information for Melancon Ball Valves

### M78 Series: 2000 • 3600 • 6000 psi

Full Port, Fire Safe, Welded End, NACE, with Lever Locking Handle, Sizes 1/4" - 2"						
Material	316 SS	Carbon Steel	316 SS	Carbon Steel	316 SS	Carbon Steel
Valve Size	2000 psi		3600 psi	3705 psi	6000 psi	6175 psi
1/4" NPTF	M14-78SW	M14-78CS	M14-78SW3	M14-78CS3	M14-78SW6	M14-78CS6
3/8" NPTF	M38-78SW	M38-78CS	M38-78SW3	M38-78CS3	M38-78SW6	M38-78CS6
1/2" NPTF	M12-78SW	M12-78CS	M12-78SW3	M12-78CS3	M12-78SW6	M12-78CS6
3/4" NPTF	M34-78SW	M34-78CS	M34-78SW3	M34-78CS3	M34-78SW6	M34-78CS6
1" NPTF	M1-78SW	M1-78CS	M1-78SW3	M1-78CS3	M1-78SW6	M1-78CS6
1-1/4" NPTF	M114-78SW	M114-78CS	M114-78SW3	M114-78CS3	M114-78SW6	M114-78CS6
1-1/2" NPTF	M112-78SW	M112-78CS	M112-78SW3	M112-78CS3	M112-78SW6	M112-78CS6
2" NPTF	M2-78SW	M2-78CS	M2-78SW3	M2-78CS3	M2-78SW6	M2-78CS6

**NOTE:** Carbon Steel A216 WCB valves have SS Ball and Stem standard.

### M325 Series - Reduced Port

### M525 Series - Full Port

3 Pc. Bolted Body - 2000 psi or 3000 psi				
Material	316 SS	Carbon Steel	316 SS	Carbon Steel
Valve Size				
1/4" NPTF	MP14-325S	MP14-325C	MP14-525S	MP14-525C
3/8" NPTF	MP38-325S	MP38-325C	MP38-525S	MP38-525C
1/2" NPTF	MP12-325S	MP12-325C	MP12-525S	MP12-525C
3/4" NPTF	MP34-325S	MP34-325C	MP34-525S	MP34-525C
1" NPTF	MP1-325S	MP1-325C	MP1-525S	MP1-525C
1-1/4" NPTF	MP114-325S	MP114-325C	MP114-525S	MP114-525C
1-1/2" NPTF	MP112-325S	MP112-325C	MP112-525S	MP112-525C
2" NPTF	MP2-325S	MP2-325C	MP2-525S	MP2-525C

**Note:** The special service option codes for the M325, M525, and M79 are located beside the next chart.

### M79 Series - Full Port

1 Piece w/ Double Union Ends up to 4500 psi		
Material	316 SS	Carbon Steel
Valve Size		
1/4" NPTF	MP14-79S	MP14-79C
3/8" NPTF	MP38-79S	MP38-79C
1/2" NPTF	MP12-79S	MP12-79C
3/4" NPTF	MP34-79S	MP34-79C
1" NPTF	MP1-79S	MP1-79C
1-1/4" NPTF	MP114-79S	MP114-79C
1-1/2" NPTF	MP112-79S	MP112-79C
2" NPTF	MP2-79S	MP2-79C

**Note:** For 4,500 psi add - K. Available on M79 series only.  
For Butt Weld Ends add - B. Available on M79 series only.  
6,000 psi valves on page 21. 10,000 psi valves. DM Series on page 18.

### Service Option Codes for M325 - M525 - M79 Series

F - Fire Safe
HS - NACE
J - 3000 psi
K - 4500 psi
P - Socket Weld Ends
D - Safety Handles
A - Oxygen Service
L - Padlock Device
Z - Paint Service
FE - Fugitive Emission
PC - Thermopac
U - UL Listing
Y - Chlorine



# MELANCON ENERGY PRODUCTS

## Trunnion Mounted Ball Valves

### “T” Series

API-6D, FULL Port, Fire Safe, NACE

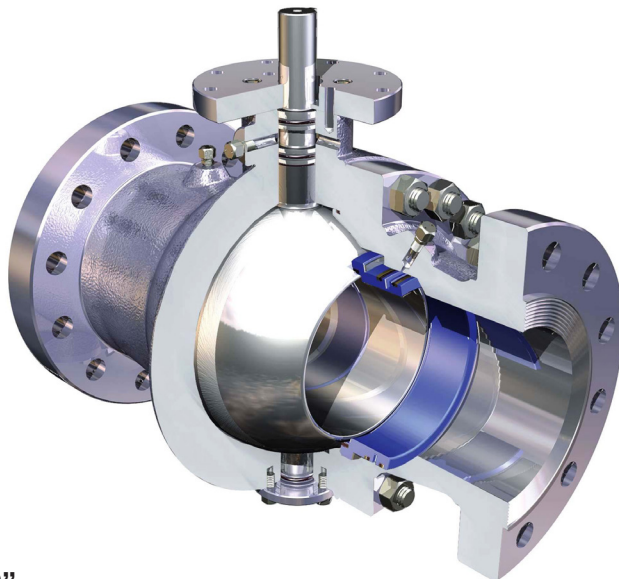

**Sizes:** 2” - 42”  
**Classes:** 150, 300, 600, 900, 1500 and 2500 (Standard ANSI Dimensions)  
**Connections:** Flanged, Weld End and Weld x Flange

#### General Applications:

Our Trunnion Mounted Ball Valves are designed for Pipelines, Compressor Stations, Standard or Severe oil and gas applications; including Production, Upstream/Downstream Processing, Transportation, Distribution, Refining and Petrochemical, as well as Power Plants and Chemical applications.

**Services Include:** Natural Gas (wet or dry), LPG, Unleaded Gasoline, Jet Fuel, Diesel, H<sub>2</sub>S, Ethylene, Crude Oil (sweet or sour), Drilling Mud, Butadiene, Ammonia, Amines and many other Chemical services.

#### Features:

1. FULL Port, Trunnion Mounted (Reduced Port available)
2. WCC / A105 Forged Steel Body, Fire Safe, NACE, Fire Tested to API-6FA, ASME B16.34
3. Double Block and Bleed, Bi-Directional Flow
4. API 6D, API 6FA, ASME VII (ISO 9001), ISO 15156 for Buried Service
5. Testing to API 6D: Hydrostatic Body Shell Test, Hydrostatic Seat Test
6. 2”, 3” & 4” Lever Operated with Gear Box optional
7. 6” & Up – Double Reduction Gear Operated for Lower Operating Torques
8. Bolted Body for 2 pc. design: Valves available up to 42”
9. Guided Stem Bearings to minimize operating torques
10. Anti-Static Device to BS 5351 between body seats, ball & stem

**Note:** All 4” and Larger Trunnion Mounted Ball valves are equipped with Secondary Seat Fittings for Injecting Valve Lube Sealant, EMERGENCY Valve Sealant, Valve Cleaner or Valve Purge into the Upstream and Downstream seats.





# MELANCON ENERGY PRODUCTS

## STANDARDS and SPECIFICATIONS for “T” Series

“T” series Trunnion Mounted Ball valves conform to the following Design & Testing standards:

- **API 6D**
- **API 6FA** (Fire Test Specification)
- **NACE** MR0175 / ISO 15156 (For Buried Service)
- **ASME/ANSI B16.34** (Valves, Flange End)
- **ASME/ANSI B16.5** (Steel Pipe Flanges & Flange Fitting)
- **MSS-SP-6** (Standard Finishes for Pipe Flanges)
- **MSS-SP-25** (Standard Marking System for Valves)
- **MSS-SP-55** (Quality Standards for Steel Castings)

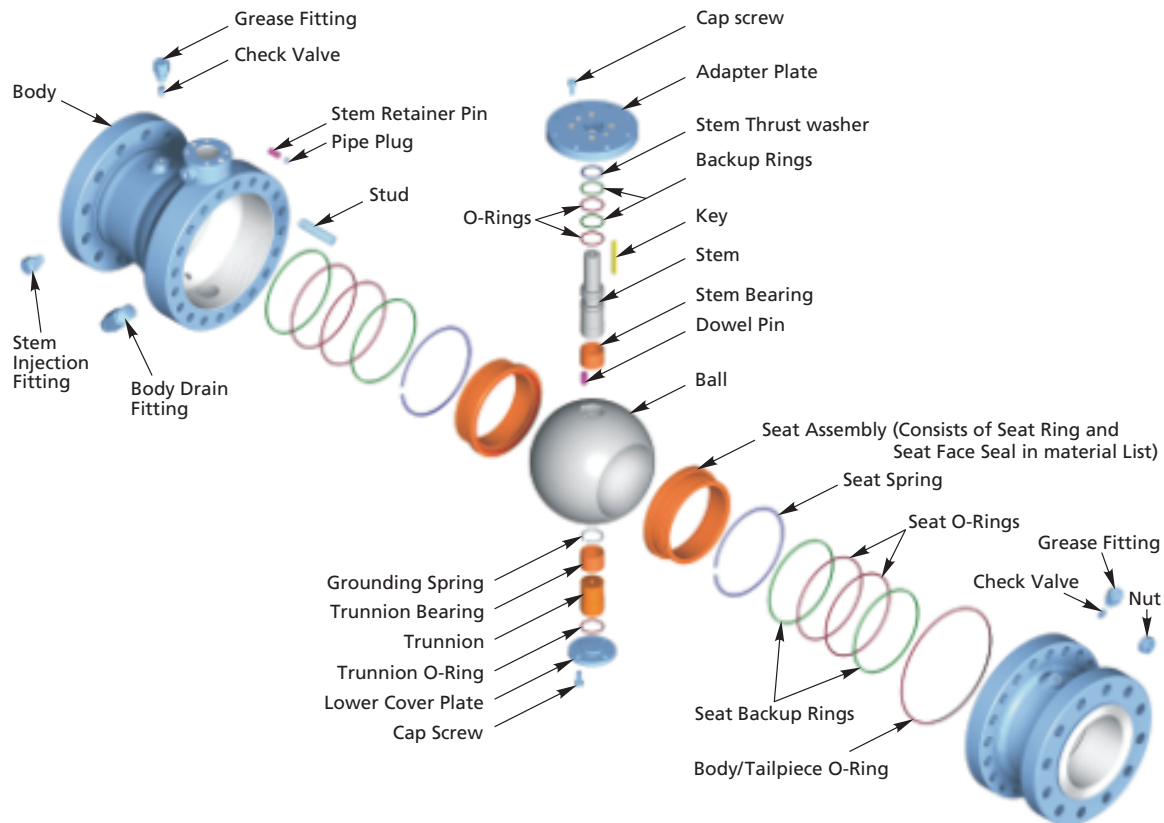





# MELANCON ENERGY PRODUCTS

## Flanged End Ball Valves\*



**Unibody**



**2 Pc. Body**

**Sizes:** 1/2" - 12"

**Classes:** ANSI 150 and 300 • Full Port and Reduced Port (Standard ANSI Dimensions)

**Standards:** WCB, WCC, 316 SS, API-6D, NACE, MR-01-75, API 607 Edition 4, ANSI B16.10, B16.5, B16.34  
MSS-SP-6, MSS-SP-25, MSS-SP-55

- Standard Features:**
1. Fire Safe - Designed and Tested to API-607 4th Edition
  2. NACE MR-01-75, 316 SS Ball & Stem
  3. Secondary metal-to-metal seating
  4. Dual Stem Seals - requires fewer adjustments in service
  5. Encapsulated Body Seal improves sealing and prevents cold flow
  6. Recessed Seats extend seat life, eliminate seat "blowout" and help prevent cold flow
  7. Conical Shaped TFE and RTFE Packing Rings
  8. Dual Packing Sets maximize seal integrity and eliminate problems commonly associated with multiple top loaded packing designs.
  9. Integral Mounting Pad ISO-5211 allows easy automation.
  10. Internal Entry Stem for maximum safety. Anti-static stem.
  11. Standard Flange Finish 125-250 microinches (Ra) compatible with industry approved gaskets.
  12. Standard Grounding Washer on all styles except Fire Gard — where the flexible graphite stem packing provides grounding.

**Service Options:** Sour Gas (NACE MR-01-75), Chlorine Service, Oxygen, Vacuum, Cryogenic, Styrene, Fugitive Emissions, Hot Oil, Thermal Fluid, Steam, Paint, U.L. Listed, Pulp & Paper Mills, Butadiene, Food Process, Pharmaceuticals, Detergent Slurry & Fire Safe Applications.

**Note:** All carbon steel WCB and WCC valves have 316 SS trim.

\*Additional Valve Specifications are available upon request.



# MELANCON ENERGY PRODUCTS

## Project Materials

### Pipe, Fittings, Flanges & Gaskets

Domestic and Import Brands.

- **Seamless, ASTM A53/106 GR B**
- **API-5L**
- **FBE Coated**
- **Welded**
- **ERW, DSAW**
- **Seamless, ASTM A312 TP 304**



Inventory Range:  
1/2" - 48", Carbon Steel,  
Stainless Steel and Alloy  
Schedule: 10, 40, 80, 160, XXH & High Yield Pipe  
Single and Double random lengths



### Fittings:

Domestic AML Brands and offer Quality Imports.  
Carbon Steel, **Stainless**, A105, ASTM 234 WPB, High Yield up to WPHY70, Elbows, 90's, 45's, Long Radius, Short Radius, Weld Caps, Eccentric or Concentric Reducers, Straight Tees & Reducing Tees.

***ALL Sizes, Schedules, Wall Thicknesses & Classes***

### Flanges

***Domestic and Import brands of Flanges.***

- Carbon Steel, A105, Stainless Steel, Alloy, High Yield up to WPHY70+
- Weld Neck, Blind Flanges, Socket Weld, Butt Weld, Threaded, Slip-On
- RF, RTJ, ANSI B16.5, 150 Class to 2500 Class
- API-6A 5000 & 10,000
- We can work from your AML / AVL or offer Alternative Brands
- **MTR Documentation** provided on All Flanges, Fittings, Valves & Pipe



### Stud Bolts with 2 Hex Nuts:

Plain, **Black**, **Plated**, **Xylan** or **Teflon Coated**

Available in ALL Sizes, Specifications, Materials & Lengths.



### Spiral Wound or Ring Joint Gaskets

***1/2" thru 42"***

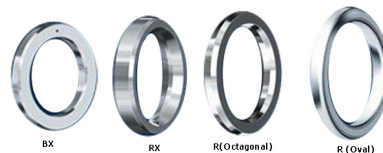



# MELANCON ENERGY PRODUCTS

## API-6A Wellhead Gate Valves



Model "M" Expanding Gate



Model "F" Slab Gate

### Valves available with all Trim Codes (AA-FF)

- API-6A Specification
- Valves for applications from 2000 to 15,000 psi WP. PSL 1-3, PSR 2
- Positive Metal to Metal sealing (gate-to-seat and seat-to-body)
- Valves fitting a wide range of land and offshore applications.
- -50° F to 650° F Service.
- Full bore through conduit construction.
- Components constructed of various alloys and coatings for severe service applications.
- MTR Documentation

#### 6A Flanged End Gate Valve Dimensions - 2000 PSI

Size	Bore	A	B	C	D	E	N	Wt.
2-1/16	2- 1/16	11.62	5.00	4.85	13	24.7	13.0	99
2-9/16	2- 9/16	13.12	5.94	5.63	13	26.3	15.5	130
3-1/8	3- 1/8	14.12	7.38	7.16	13	29.9	20.0	180
4-1/16	4- 1/16	17.12	8.88	8.38	16	34.7	24.5	356
7-1/16	6	22.12	13.12	12.88	24	52.0	30.0	840
7-1/16	7- 1/16	26.12	16.00	14.50	30	41.5	32.0	840

#### 6A Flanged End Gate Valve Dimensions - 3000 PSI

Size	Bore	A	B	C	D	E	N	Wt.
2-1/16	2- 1/16	14.62	5.12	4.85	13	24.7	13	162
2-9/16	2- 9/16	16.62	6.25	5.63	13	26.6	15.5	207
3-1/8	3- 1/8	17.12	7.38	7.16	13	29.9	20	240
4-1/16	4- 1/16	20.12	9.00	8.38	16	34.8	24.5	450
7-1/16	7- 1/16	26.12	15.00	14.50	30	41.5	32	1118

#### 6A Flanged End Gate Valve Dimensions - 5000 PSI

Size	Bore	A	B	C	D	E	N	Wt.
2-1/16	2- 1/16	14.62	5.12	4.85	13	24.7	13	162
2-9/16	2- 9/16	16.62	6.25	5.63	13	26.6	15.5	207
3-1/8	3- 1/8	18.62	7.69	7.16	13	30.2	20	307
4-1/16	4- 1/16	21.62	9.31	8.38	20	345.6	24.5	560
7-1/16	7- 1/16	32.00	15.50	14.50	30	42	32.0	1398

### Model "M"

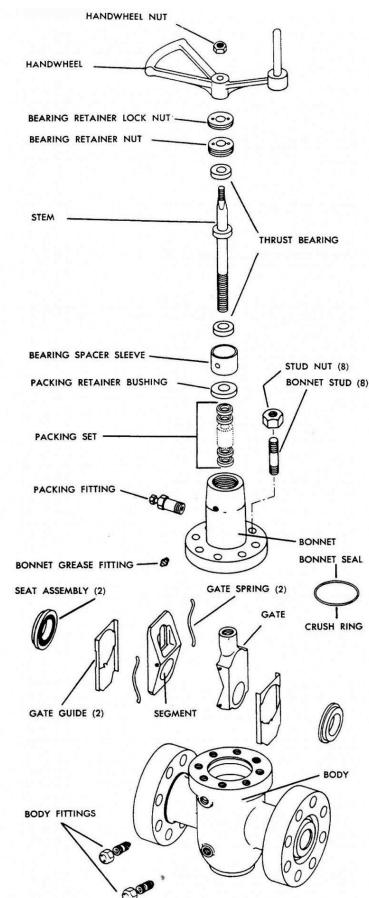

### Model "F"

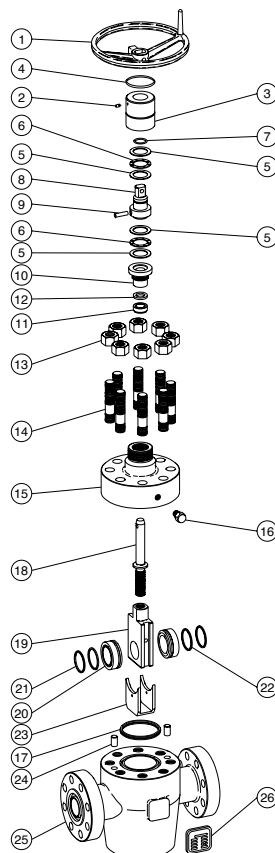

Size in inches.  
Weights in pounds.  
N = No. of turns to open

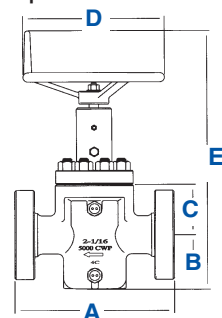

**Note:** 10,000 and 15,000 psi charts are available upon request.



# MELANCON ENERGY PRODUCTS

## Premium Gauges LF Series

### Features:

- 2-1/2", 4", 6" and 10" white aluminum dials with black markings
- 316 SS Bourdon Tube and Socket
- 304 stainless steel internals
- Liquid filled or dry NACE MR-01-75
- 2-1/2" - 1.5% filled, NASI / ASME Grade A,
- 1% dry, ANSI / ASME Grade 1 A
- 4" & 6" - 1% filled, ANSI / ASME Grade 1A
- 1/2% dry, ANSI / ASME, Grade 2A
- 1/4", 1/2" NPT bottom or back connection
- Restrictor screw standard

### Applications:

- Pipelines, compressor stations, gas plants, pumps, hydraulic presses & machinery, motors, winches, etc. Where vibration occurs and / or pressure fluctuates constantly

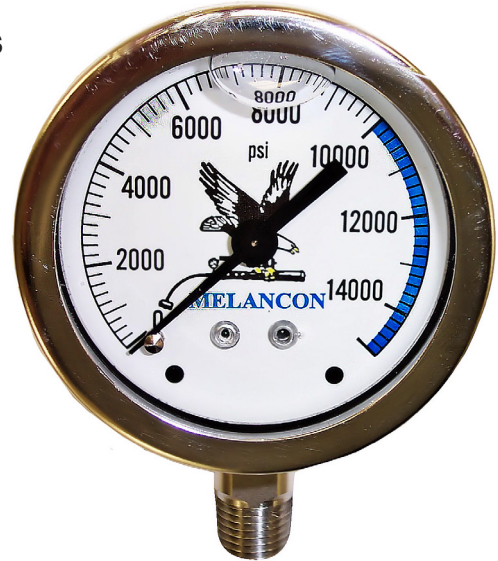

**Note:** Available with 10" Dial

Dial Size	2-1/2"		4"				4"			6"		
Connection	Bottom	Back	Bottom	Bottom	Back	Back	Bottom	Bottom	Back	Bottom	Bottom	Back
NPT Male Connection	1/4"	1/4"	1/4"	1/2"	1/4"	1/2"	1/4"	1/2"	1/4"	1/4"	1/2"	1/4"
Movement socket, tube	St/St	St/St	Brass	Brass	Brass	Brass	St/St	St/St	St/St	St/St	St/St	St/St
Glycerin Filled	Filled	Filled	Filled	Filled	Filled	Filled	Filled	Filled	Filled	Filled	Filled	Filled
30" Hg Vacuum	P820	P840	P600	*	P1000	*	P640	P655	P1090	P1078	*	P1168
30" - 0 - 15 psi	P860	P870	P1020	*	P1028	*	P1036	P1044	*	P1079	*	*
30" - 0 - 30 psi	P861	P871	P1021	*	P1029	*	P1037	P1045	*	P1052	*	*
30" - 0 - 60 psi	P862	P872	P1022	*	P1030	*	P1038	P1046	*	P1053	*	*
30" - 0 - 100 psi	P863	P873	P1023	*	P1031	*	P1039	P1047	*	P1054	*	*
30" - 0 - 150 psi	P864	P874	P1024	*	P1032	*	P1040	P1048	*	P1055	*	*
30" - 0 - 200 psi	P866	P876	P1026	*	P1034	*	P1042	P1050	*	P1057	*	*
30" - 0 - 300 psi	P867	P877	P1027	*	P1035	*	P1043	P1051	*	P1058	*	*
0 - 15 psi	P821	P921	P601	*	P1001	*	P641	P656	P1091	P1059	*	P1159
0 - 30 psi	P822	P922	P602	*	P1002	*	P642	P657	P1092	P1060	*	P1160
0 - 60 psi	P823	P923	P603	*	P1003	*	P643	P658	P1093	P1061	*	P1161
0 - 100 psi	P824	P924	P604	*	P1004	*	P644	P659	P1094	P1062	*	P1162
0 - 160 psi	P825	P925	P605	*	P1005	*	P645	P660	P1095	P1063	*	P1163
0 - 200 psi	P826	P926	P606	*	P1006	*	P646	P661	P1096	P1064	*	P1164
0 - 300 psi	P827	P927	P607	*	P1007	*	P647	P662	P1097	P1065	*	P1165
0 - 400 psi	P880	P881	P610	*	P1016	*	P650	P666	*	P1077	*	*
0 - 600 psi	P828	P928	P608	*	P1008	*	P648	P663	P1098	P1066	*	P1166
0 - 1000 psi	P829	P929	P609	P624	*	P1009	P649	P664	P1099	P1067	P1080	P1167
0 - 1500 psi	P834	P934	*	P625	*	P1010	*	P665	*	P1068	P1081	*
0 - 2000 psi	P830	P930	*	P626	*	P1011	*	P667	*	P1069	P1082	*
0 - 3000 psi	P831	P931	*	P627	*	P1012	*	P668	*	P1070	P1083	*
0 - 5000 psi	P832	P852	*	P628	*	P1013	*	P669	*	P1072	P1085	*
0 - 10,000 psi	P833	P853	*	P629	*	P1014	*	P670	*	P1073	P1086	*
0 - 15,000 psi	P835	P855	*	P630	*	P1018	*	P671	*	P1074	P1087	*
0 - 20,000 psi	P836	*	*	P639	*	P1019	*	P672	*	P1075	P1088	*

**Note:** D - For Dry Gauges; UC - U-Clamp; FF - Front Flange; BF - Back Flange; SG - Safety Glass Lens.

\* Not available on Premium Gauges. Available in our "Q" Series. Call for details.





# MELANCON ENERGY PRODUCTS

## Process Gauges

### Features:

- 4-1/2" (115 mm) Dial
- Restrictor screw
- Acrylic lens
- Black impact resistant Phenolic case
- Reinforced polypropylene ring
- Brass or 316 SS bourdon tube & socket
- Stainless steel movement
- Silver braised or welded joints
- Liquid filled or dry (field fillable)
- Integral back flange
- Safety blowout back-plate, solid front
- 0.5% accuracy dry, ANSI / ASME Grade 2A
- 1% accuracy filled, ANSI / ASME Grade 1A
- Micrometer adjustable pointer



### Applications:

Process, chemical & petroleum industries, etc. & severe service applications. Pipelines, compressor stations, gas plants and refineries.

#### Part No.

Connection	Bottom	Bottom	Bottom
NPT Male			
Connection Size	1/4"	1/4"	1/2"
Socket & tube	Brass	St / St	St / St
Movement	St / St	St / St	St / St
30" Hg Vacuum	P5080	P5040	P5060
30" -0- 15 psi	P5120	P5130	P5140
30" -0- 30 psi	P5121	P5131	P5141
30" -0- 60 psi	P5122	P5132	P5142
30" -0- 100 psi	P5123	P5133	P5143
30" -0- 160 psi	P5124	P5134	P5144
30" -0- 200 psi	P5125	P5135	P5145
30" -0- 300 psi	P5126	P5136	P5146
0 - 15 psi	P5081	P5041	P5061
0 - 30 psi	P5082	P5042	P5062
0 - 60 psi	P5083	P5043	P5063
0 - 100 psi	P5084	P5044	P5064
0 - 160 psi	P5085	P5045	P5065
0 - 200 psi	P5086	P5046	P5066
0 - 300 psi	P5087	P5047	P5067
0 - 400 psi	P5088	P5048	P5068
0 - 600 psi	P5089	P5049	P5069
0 - 1000 psi	P5098	P5050	P5070

#### Part No.

Connection	Bottom	Bottom	Bottom
NPT Male			
Connection Size	1/2"	1/4"	1/2"
Socket & tube	Brass	St / St	St / St
Movement	St / St	St / St	St / St
0 - 1000 psi	P5090	P5050	P5070
0 - 1500 psi	P5091	P5051	P5071
0 - 2000 psi	P5092	P5052	P5072
0 - 3000 psi	P5093	P5053	P5073
0 - 5000 psi	P5094	P5054	P5074
0 - 10,000 psi	P5095	P5055	P5075
0 - 15,000 psi	P5096	P5056	P5076
0 - 20,000 psi	P5097	P5057	P5077

Receiver Gauge : 0-15 psi / 0-100% Part No. P5061R

**Options:** For Glycerin Filled add - **G**  
 For Silicone Filled add - **SF**  
 For Back Connection add - **B** (not fillable)  
 For Monel Socket & Tube add - **MS**

**Note:** Other ranges are available upon request.



# MELANCON ENERGY PRODUCTS

## Test Gauges

### Features:

- 6" (150 mm) Dial
- Accuracy 0.25% of full scale, ANSI / ASM Grade 3A
- 4" (100 mm) dial
- Accuracy 0.5% of full scale, ANSI / ASME Grade 2A
- 304 Stainless steel case
- 1/4" or 1/2" NPT bottom connection
- 316 Beryllium copper tube & brass socket
- High precision movement
- Anti-parallax mirror dial
- Balanced anti-parallax knife edge adjustable micrometer pointer
- Glass lens
- Bayonet ring
- NIST traceable test certificate standard



### Applications:

- Pipelines, Production, Laboratories or Instrument Testing, where accuracy and repeatability are of prime importance.

### Part No.

Dial Size	4" (100 mm)	6" (150 mm)	4" (100 mm)	6" (150 mm)
Tube	Beryllium Copper	Beryllium Copper	Beryllium Copper	Beryllium Copper
Socket & Movement	Brass	Brass	Brass	Brass
Connection	Bottom	Bottom	Bottom	Bottom
NPT Connection	1/4"	1/4"	1/2"	1/2"
0 / 15 psi	P4000	P2000	*	*
0 / 30 psi	P4001	P2001	*	*
0 / 60 psi	P4002	P2002	*	*
0 / 100 psi	P4003	P2003	*	*
0 / 160 psi	P4004	P2004	*	*
0 / 200 psi	P4005	P2005	*	*
0 / 300 psi	P4006	P2006	*	*
0 / 400 psi	P4007	P2007	*	*
0 / 600 psi	P4008	P2008	*	*
0 / 1000 psi	*	*	P4009	P2009
0 / 1500 psi	*	*	P4010	P2010
0 / 2000 psi	*	*	P4011	P2011
0 / 3000 psi	*	*	P4012	P2012
0 / 6000 psi	*	*	P4013	P2013
0 / 10,000 psi	*	*	P4014	P2014

### Options:

- 0.10% accuracy available on request. • Back connection available upon request • Add the suffix **-B** for back connection.
- Back flange, front flange and u-clamp options available upon request. • Other ranges and connection sizes available upon request.
- Test Gauge Protective Case: for 4" part no. **TGC-4**  
for 6" part no. **TGC-6**



# MELANCON ENERGY PRODUCTS

## Differential Gauges

### Features:

- 4-1/2" or 6" Dial
- Black anodized aluminum case or stainless steel
- Aluminum pointer painted black
- Matched independent phosphor bronze or stainless steel tubes
- Specially designed heavy duty phosphor bronze differential movement
- 1% of full scale accuracy, ANSI / ASME Grade 1A
- 1/4" NPT standard, 1/2" NPT available
- Back flange standard on bottom connection
- Front flange standard on back connection



### Applications:

Single pointer gauge for displaying the difference between two different, but related pressures on the same dial, e.g., for use on pumps and filters.

### Part No.

Dial Size	4-1/2"		6"	
Tube & Socket	Brass	St / St	Brass	St / St
Connection	1/4" NPT Bottom			
0 / 15 psi	P8051	P8061	P8071	P8081
0 / 30 psi	P8052	P8062	P8072	P8082
0 / 60 psi	P8053	P8063	P8073	P8083
0 / 100 psi	P8054	P8064	P8074	P8084
0 / 160 psi	P8055	P8065	P8075	P8085
0 / 200 psi	P8056	P8066	P8076	P8086
0 / 300 psi	P8057	P8067	P8077	P8087
0 / 600 psi	P8058	P8068	P8078	P8088
Special Range	P8050	P8060	P8070	P8080

**Note:** For Back Connection add - B      **Example:** P8064-B  
High Pressure / Low Pressure configurations are also available.

The following types of gauges and products are readily available:

- Diaphragm Seals
- Differential Pressure Gauges
- Duplex Gauges
- Economy Gauges
- Low Pressure Gauges
- Instrument Manifolds/Needle Valves (see page 33)
- Process Gauges (see page 29)
- Remote Reading Thermometers
- RTDS
- Snubbers
- Test Gauges (see page 30)
- Thermowells
- 3A Sanitary Gauges: for Dairy, Food Processing, Chemical Industry and Pharmaceuticals.
- Temperature Transmitters
- Transmitters: Pressure, Differential Pressure, Analog
- Tridicators

**Note:** A complete gauge catalog is available upon request.



# MELANCON ENERGY PRODUCTS

## Gauge Kits

### GK-3SS

Part No.	Description
<b>GK-2SS</b>	Kits consist of two 316 SS gauges: 2-1/2" face, 1/4" NPT bottom mount, liquid filled & a Protective carrying case with a soft foam insert.  All 2-1/2" and 4" gauge kits have a stainless steel case with 316 SS socket & tube.
<b>GK-3SS</b>	Kits consist of 3 gauges: (Same as above )
<b>Note:</b>	Please specify the desired pressure ranges for the gauges in each kit. (A gauge chart is shown on page 28.)



### GK4-2SS



Part No.	Description
<b>GK4-2SS</b>	Kits consist of two 316 SS gauges with 4" face, 1/2" NPT bottom mount, liquid filled, and a protective carrying case with a soft foam insert.
<b>Note:</b>	Please specify the desired pressure ranges for the gauges in each kit. (A gauge chart is shown on page 28.)





# MELANCON ENERGY PRODUCTS

## Instrument Manifolds and Needle Valves



**MA3-12SS**

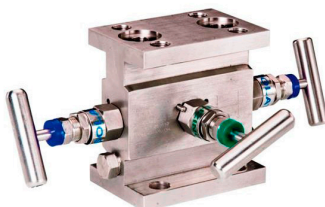

**MA3-FLSS**



**MA5-FLSS**

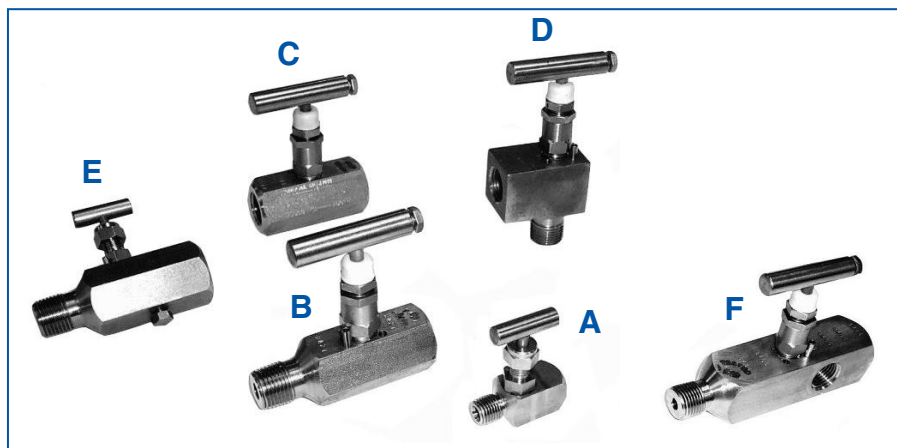

- A.** Mini Valve
- B.** Needle Valve - M x F
- C.** Needle Valve - F x F
- D.** Angle Valve
- E.** Gauge Valve w/ block & bleed
- F.** Gauge Valve w/ multi-outlet

### Standard Features:

- Body Material: Carbon Steel or 316 SS
- NACE (MR-01-75)
- Packing: Teflon®, Viton®, or Grafoil®
- Seats: Soft or Hard (please specify)
- Ratings: 6,000 or 10,000 psig  
(Mini Valve 3000 or 6000 psig)
- Temperature: Mini valves - up to 500° F,  
Needle Valves & Manifolds: up to 1,000° F.

Valve Types	Standard Connections	Options
<b>MV</b> - Mini Valve (please specify round or T handle)	<b>14</b> - 1/4" NPT	<b>B</b> - Brass (mini valve ONLY) 3000 psi ONLY
<b>NV</b> - Needle Valve	<b>12</b> - 1/2" NPT	<b>PB</b> - Phenolic Black Round Handle (mini valve ONLY)
<b>AV</b> - Angle Valve	<b>34</b> - 3/4" NPT	<b>38</b> - Large Bore: .375 inch
<b>GV</b> - Gauge Valve	<b>1</b> - 1" NPT	<b>SS</b> - 316 Stainless Steel
<b>GVB</b> - Gauge Valve w/block & bleed	<b>F</b> - Female x Female NPT	<b>MO</b> - Monel®
<b>MA2</b> - 2 Valve Manifold	<b>M</b> - Male x Male NPT	<b>SP</b> - Special Requirements (please specify)
<b>MA3</b> - 3 Valve Manifold	<b>MF</b> - Male x Female NPT	<b>10</b> - 10,000 psi rated (needle valves ONLY)
<b>MA5</b> - 5 Valve Manifold	<b>FL</b> - Flange	<b>BL</b> - Bonnet Lock

**Examples:** MV14 - FSS, NV12 - MFSS, MA5 - 38FLSS

All valves and manifolds are **100%** pressure tested. Additional information is available upon request.

**Note:** When ordering, please specify the codes for valve type, connections & any options you may require.  
For 1/2" NPT Male x 1/4" NPT Female use the code **1214**.



# MELANCON ENERGY PRODUCTS

## Closures, Ratchet Assemblies & Pressure Alert Valves

Melancon represents Huber-Yale™ Closures:



All Sizes, Types & Classes including:  
Horizontal, Vertical and Angle type.  
150 through 2500 Class

### Figure 500 Closures (2"-14")

- Hubs & cap have a flat face seat
- Closed die forgings are SA-350 LF2 material.
- Castings are SA-352 LCB material.
- External lugs on the caps (Pressure Alert Valve standard on ALL 6" and above)
- 4-pitch threads on 2" and 3 "
- 3-pitch threads on 4"
- 2-pitch threads on 6"-14"
- Three available hinge designs: Horizontal, Vertical & Angle

### Figure 515™ Flanged Yale™ Closure

- The Figure 515 offers a bolted Flange-to Flange configuration.
- New vessel constructions
- Replaces blind flanges, without additional welding
- Available in sizes from 2" to 72"
- ANSI Class 150 through 2500

### Figure 500-R Large Size Closures

### (16" and Larger)

- Hubs & cap are machined with a 30-degree bevel seat that has many advantages over flat face seats
- Minimum of 3" thread length
- Superior O-ring seal retention groove
- Less risk for damage to sealing surface of hub
- Provides stabbing section on hub
- Greater tolerance for diametrical and lateral warpage
- SA-516 GR 70 formed steel plate for caps
- Subs machined from SA-105, SA-350 LF2 or A-694 forged steel ring
- 1-pitch modified Acme threads
- Serial numbers for quick identification
- Closure actuation tool (CAT™) included for tightening/loosening cap
- Three available hinge designs: horizontal, vertical & angle

## Huber Yale™ Closure Part Numbers for 2" thru 60"

Closure Size	Fig. 500	Huber Yale™ Fig. 500-R	Closure Size	Huber Yale™ Fig. 500-R
	2" - 14"	16" - 28"		30" - 72"
2"	HY2-6	**	30"	HY30-5R6
3"	HY3-6	**	32"	HY32-5R6
4"	HY4-6	**	34"	HY34-5R6
6"	HY6-6	**	36"	HY36-5R6
8"	HY8-6	**	38"	HY38-5R6
10"	HY10-6	**	40"	HY40-5R6
12"	HY12-6	**	42"	HY42-5R6
14"	HY14-6	**	44"	HY44-5R6
16"	**	HY16-5R6	46"	HY46-5R6
18"	**	HY18-5R6	48"	HY48-5R6
20"	**	HY20-5R6	50"	HY50-5R6
22"	**	HY22-5R6	52"	HY52-5R6
24"	**	HY24-5R6	56"	HY56-5R6
26"	**	HY26-5R6	60"	HY60-5R6
28"	**	HY28-5R6		

We provide MTR's for ALL of our Closures.

### Ratchet Assemblies for Closure sizes up to 60"



Part No.	RA-HYSM	fits sizes 16" - 22"
Part No.	RA-HYLG	fits 24" & Larger



**PAV-12 Pressure Alert Valve,**  
1/2" NPT with Safety Chain.  
**PAV-12-SS** in Stainless Steel



# MELANCON ENERGY PRODUCTS

## Closure Seals\*

For Pig Launchers, Pig Receivers,  
Blow-Downs and Vessels



We STOCK our Closure Seals, Pressure Alert  
Valves & Ratchet Assemblies.

Closure Size	Huber-Yale™		Tube-Turn™ Double Bolt
	Fig. 500	Fig. 510	
2"	CS -2-V	**	**
3"	CS -3-V	**	**
4"	CS -4-V	**	**
6"	CS -6-V	CS -6-V51	**
8"	CS -8-V	CS -8-V51	CS -8-VTT
10"	CS -10-V	CS -10-V51	CS -10-VTT
12"	CS -12-V	CS -12-V51	CS -12-VTT
14"	CS -14-V	CS -14-V51	CS -14-VTT
16"	CS -16-V	CS -16-V51	CS -16-VTT
18"	CS -18-V	CS -18-V51	CS -18-VTT
20"	CS -20-V	CS -20-V51	CS -20-VTT
22"	CS -22-V	CS -22-V51	CS -22-VTT
24"	CS -24-V	CS -24-V51	CS -24-VTT
26"	CS -26-V	CS -26-V51	CS -26-VTT
28"	CS -28-V	CS -28-V51	CS -28-VTT

Closure Size	Huber-Yale™		Tube-Turn™ Double Bolt
	Fig. 500	Fig. 510	
30"	CS -30-V	CS -30-V51	CS -30-VTT
32"	CS -32-V	CS -32-V51	CS -32-VTT
34"	CS -34-V	CS -34-V51	CS -34-VTT
36"	CS -36-V	CS -36-V51	CS -36-VTT
38"	CS -88-V	**	CS -38-VTT
40"	CS -40-V	**	CS -40-VTT
42"	CS -42-V	**	**
44"	CS -44-V	**	**
46"	CS -46-V	**	**
48"	CS -48-V	**	**
50"	CS -50-V	**	**
52"	CS -52-V	**	**
54"	CS -54-V	**	**
56"	CS -56-V	**	**

\*All Closure Seals are Viton™ (other elastomers are available)

**Note:** Larger sizes and special seals are available upon request.  
**PAV-12** Pressure Alert Valve for closure seals, 1/2" NPT

Most of our Closure Seal orders  
ship the Same Day.



# MELANCON ENERGY PRODUCTS

## Penetrating Oil & Degreaser



### ***ESPEN Oil***



## ***Environmentally Safe Penetrating Oil***

### Features:

- **Biodegradable & Non-Flammable**
- **Lubricates & Penetrates**
- **Nonconductive & Nondrying Formula**
- **Loosens Rust, Protects Metal & Stops Corrosion**
- **Dissolves Carbon Deposits**
- **Not Harmful to Rubber, Plastics & Painted Surfaces**

### Applications:

- **Pipelines, Oilfield & Production**
- **Refinery & Petrochemical**
- **Marine & Offshore Platforms**
- **Industrial & Home**

### Ordering Information:

Part No.	Packaging
<b>ESPEN-Oil-1B</b>	12 oz. Aerosol Can (12 cans per box)
<b>ESPEN-Oil-1G</b>	1 Gallon Cans (4 cans per case)
<b>ESPEN-Oil-5G</b>	5 Gallon pail with pour spout



### **Melancon DG-100 Degreaser (Environmentally Safe)**

**DG-100** is an excellent cleaner/solvent for degreasing and heavy duty cleaning.

It does not contain any petroleum distillates, acid, phosphate, alkalies, chlorides or butyl. It is safe on metals such as aluminum, copper and steel.

**DG-100** is biodegradable, non-caustic and water dispersible.

**Melancon DG-100** may be diluted with ordinary tap water. When diluted, this product will form a stable, milky white solution.

### Dilution Ratios:

- |              |   |
|--------------|---|
| 1:10 to 1:20 | Presoaking - engines, parts cleaning, extremely tough jobs such as Valve Lubrication Pumps. |
| 1:21 to 1:64 | Routine maintenance, pressure cleaning and steam cleaning                                   |
| 1:128        | Deodorizing   |

### Ordering Information:

Part No.	Packaging
<b>DG-100-1G</b>	1 gallon cans
<b>DG-100-5G</b>	5 gallon pail w/ pour spout
<b>DG-100-55</b>	55 gallon drum

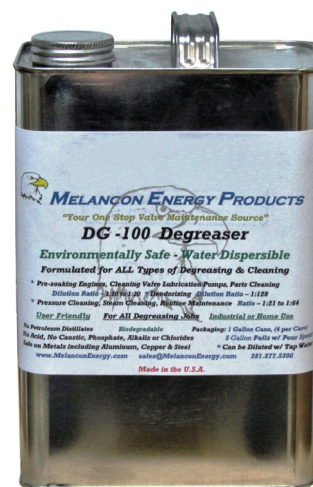





# MELANCON ENERGY PRODUCTS

## MELANCON ENERGY PRODUCTS, INC. LIMITED WARRANTY

Items sold by [Melancon Energy Products](#) are warranted to be free from defects in material and workmanship for a period of **ONE YEAR** from the date of purchase. Warranty may be voided if said items are not used according to recommended usage. [Melancon Energy Products](#) liability is limited to the repair of, or replacement in kind of, any item proved defective. Whether the defective items are repaired or replaced will be the sole option of [Melancon Energy Products](#) and the defective items must be returned to [Melancon Energy Products](#) prepaid. The warranties expressed above are in lieu of and exclusive of all other warranties. **THERE ARE NO OTHER WARRANTIES, EXPRESSED OR IMPLIED, EXCEPT AS STATED HEREIN.**

### Damages:

[Melancon Energy Products](#) is not liable for damages of any type (whether direct, consequential, incidental or special) arising out of or in connection with, the manufacture, sale, delivery, handling or any other use of MEP products. Our only obligation is to replace any [Melancon Energy Products](#) item proved to be defective.

[Melancon Energy Products](#) reserves the right to discontinue manufacture of any product or change product materials, design, or specifications without notice.

Information contained in this catalog and the contents are subject to change without notice.



P.O. Box 1848 Stafford, Texas 77497-1848  
 MelanconEnergy.com

281. 277.5300 Fax: 281.277.5303  
 800.343.1610

